

EC Centrifugal Fan Backward Curved Ø133x63mm

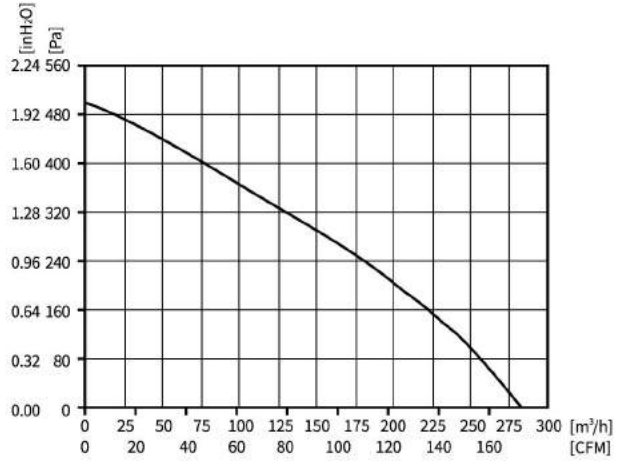

Backward Curved Centrifugal Fans

Motor Type EC BRUSHLESS EXTERNAL ROTOR MOTOR	Speed Control 0-10VDC/PWM	Protection Type IP55	Insulation Class B	Operating Temperature -25°C ~ +60°C	Weight 0.6KG	Wiring Mode E1
---	------------------------------	-------------------------	-----------------------	--	-----------------	-------------------

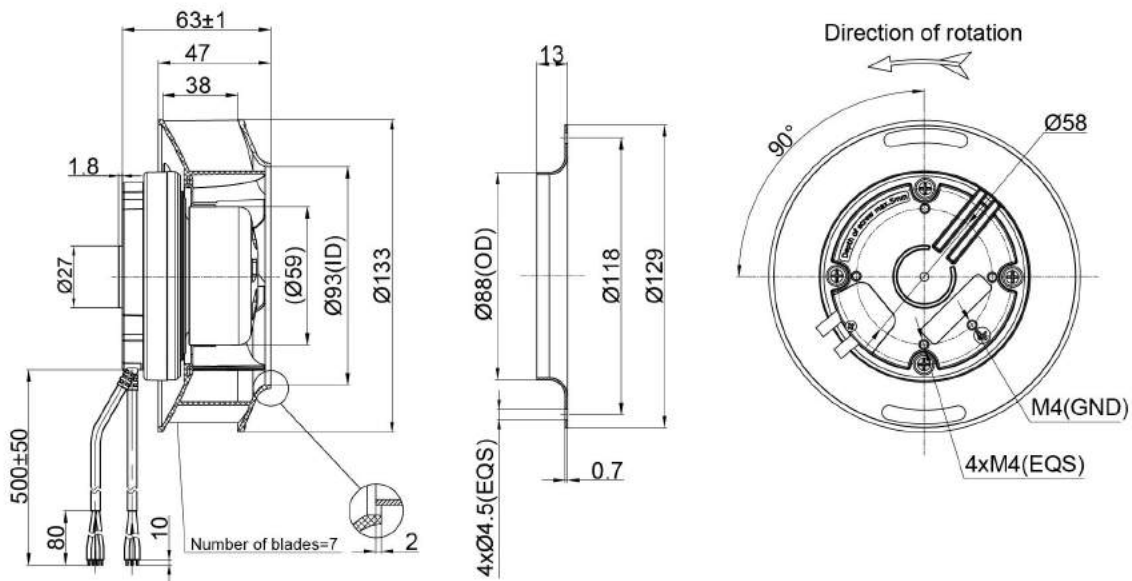

Model	Motor	Bearing System	Rated Voltage	Frequency	Rated Current	Rated Power	Rated Speed	Air Flow	Air Pressure	Sound Level
Part No.	Type	B/S	VAC	Hz	A	W	RPM	M ³ /H	Pa	dB(A)
PB3N133B2E-FZ5	BE59EC	BALL	230	50/60	0.25	34	4450	280	500	65

EC Centrifugal Fan backward Curved Ø133x63mm

Backward Curved Centrifugal Fans

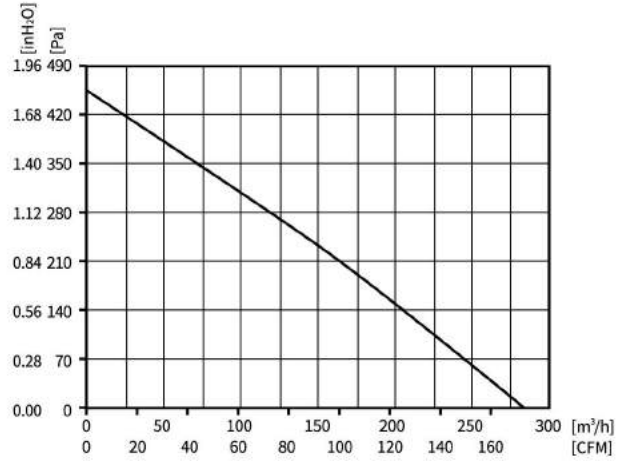

Motor Type EC BRUSHLESS EXTERNAL ROTOR MOTOR	Speed Control 0-10VDC/PWM	Protection Type IP55	Insulation Class B	Operating Temperature -25°C ~ +60°C	Weight 0.6KG	Wiring Mode E1
---	------------------------------	-------------------------	-----------------------	--	-----------------	-------------------

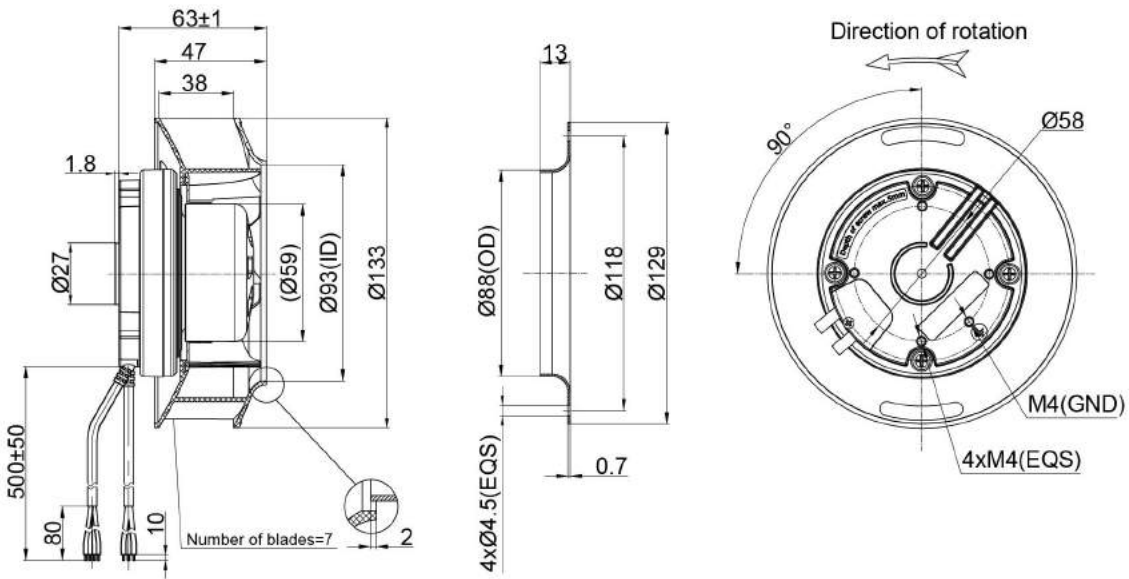

Model	Motor	Bearing System	Rated Voltage	Frequency	Rated Current	Rated Power	Rated Speed	Air Flow	Air Pressure	Sound Level
Part No.	Type	B/S	VAC	Hz	A	W	RPM	M ³ /H	Pa	dB(A)
PB3N133B2E-FZ0	BE59EC	BALL	230	50/60	0.2	30	4250	281	459	64

EC Centrifugal Fan Backward Curved Ø133x110mm

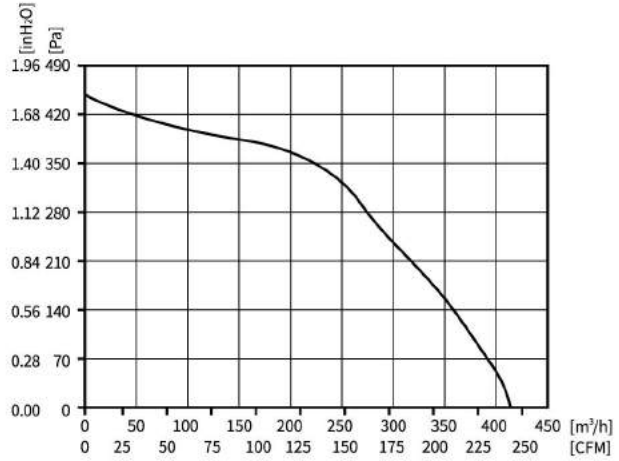

Backward Curved Centrifugal Fans

Motor Type EC BRUSHLESS EXTERNAL ROTOR MOTOR	Speed Control 0-10VDC/PWM	Protection Type IP55	Insulation Class B	Operating Temperature -25°C ~ +60°C	Weight 0.65KG	Wiring Mode E1
---	------------------------------	-------------------------	-----------------------	--	------------------	-------------------

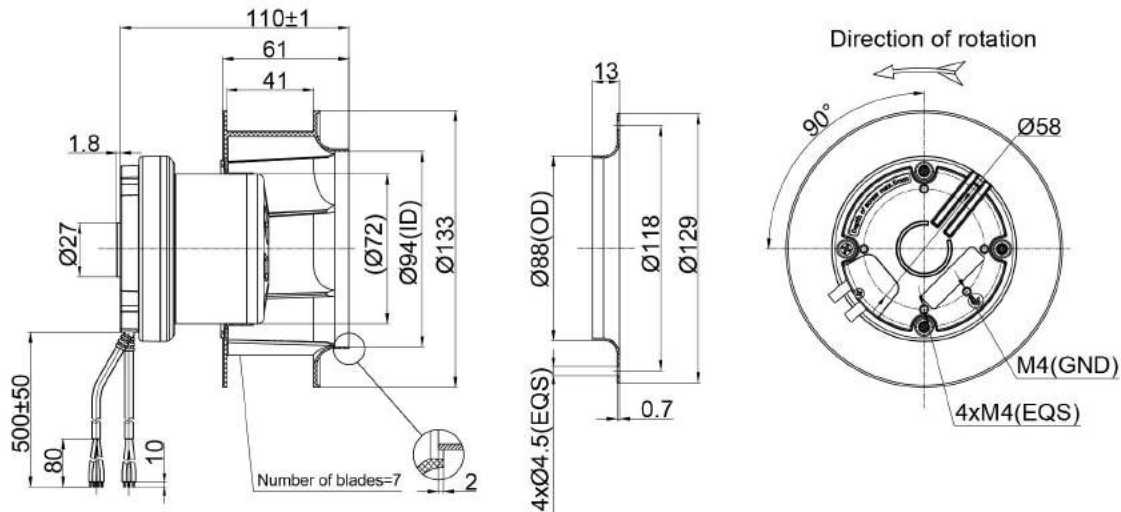

Model	Motor	Bearing System	Rated Voltage	Frequency	Rated Current	Rated Power	Rated Speed	Air Flow	Air Pressure	Sound Level
Part No.	Type	B/S	VAC	Hz	A	W	RPM	M³/H	Pa	dB(A)
PB3N133B2E-RB2	BE72EC	BALL	230	50/60	0.3	43	4400	415	450	70

EC Centrifugal Fan Backward Curved Ø175x68.5mm

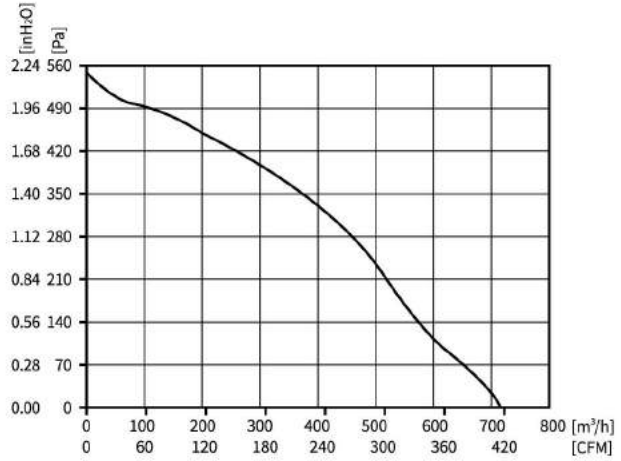

Backward Curved Centrifugal Fans

Motor Type EC BRUSHLESS EXTERNAL ROTOR MOTOR	Speed Control 0-10VDC/PWM	Protection Type IP55	Insulation Class B	Operating Temperature -25°C ~ +60°C	Weight 1.3KG	Wiring Mode E1
---	------------------------------	-------------------------	-----------------------	--	-----------------	-------------------

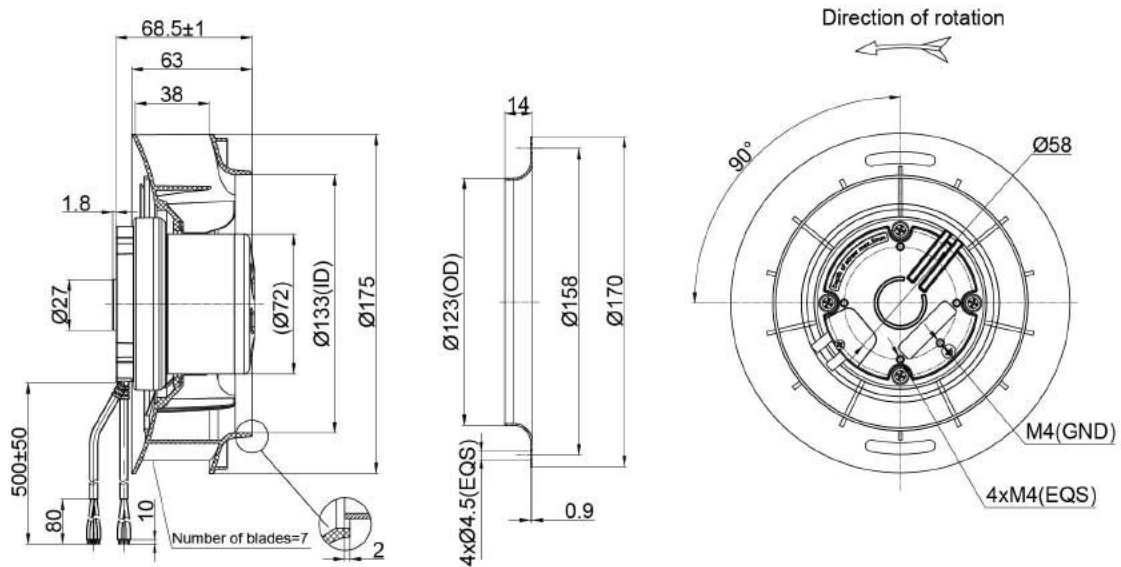

Model	Motor	Bearing System	Rated Voltage	Frequency	Rated Current	Rated Power	Rated Speed	Air Flow	Air Pressure	Sound Level
Part No.	Type	B/S	VAC	Hz	A	W	RPM	M ³ /H	Pa	dB(A)
PB3N175B2E-RZ0	BE72EC	BALL	230	50/60	0.6	72	4050	710	550	72

EC Centrifugal Fan backward Curved Ø175x68.5mm

Backward Curved Centrifugal Fans

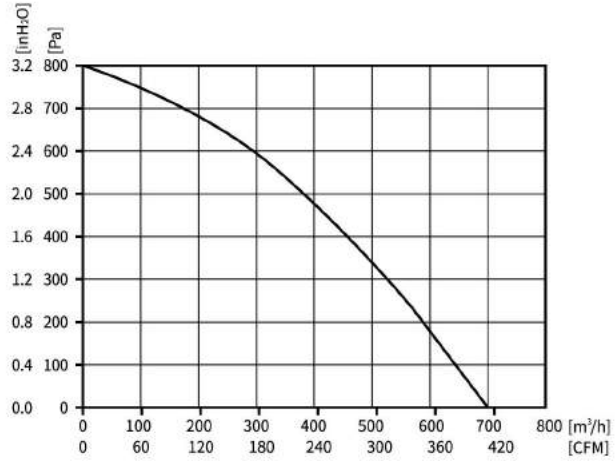

Motor Type EC BRUSHLESS EXTERNAL ROTOR MOTOR	Speed Control 0-10VDC/PWM	Protection Type IP55	Insulation Class B	Operating Temperature -25°C ~ +60°C	Weight 1.5KG	Wiring Mode E1
---	------------------------------	-------------------------	-----------------------	--	-----------------	-------------------

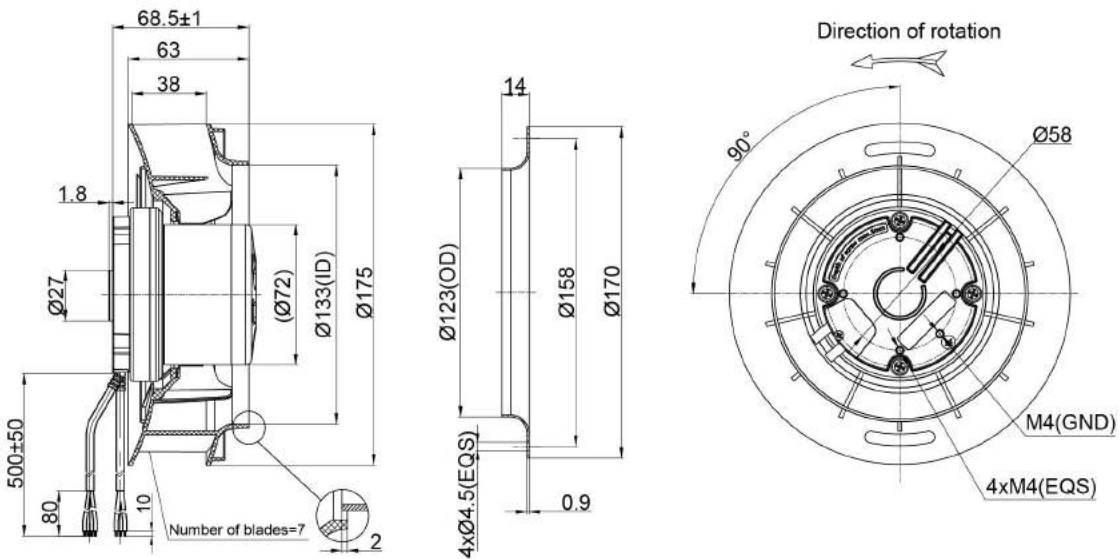

Model	Motor	Bearing System	Rated Voltage	Frequency	Rated Current	Rated Power	Rated Speed	Air Flow	Air Pressure	Sound Level
Part No.	Type	B/S	VAC	Hz	A	W	RPM	M ³ /H	Pa	dB(A)
PB3N175B2E-SZ0	BE72EC	BALL	230	50/60	0.75	110	4600	700	800	74

EC Centrifugal Fan Backward Curved Ø190x68.5mm

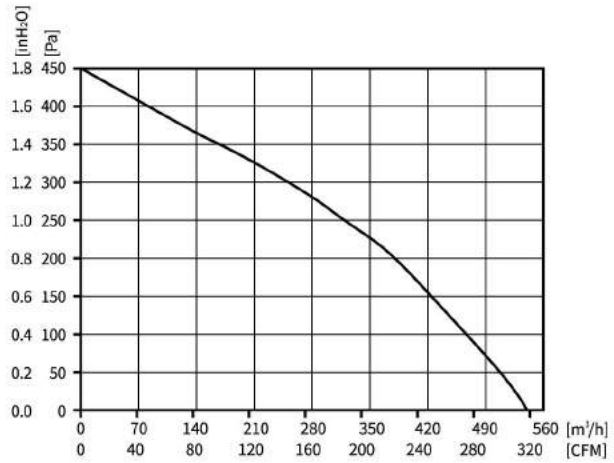

Backward Curved Centrifugal Fans

Motor Type EC BRUSHLESS EXTERNAL ROTOR MOTOR	Speed Control 0-10VDC/PWM	Protection Type IP55	Insulation Class B	Operating Temperature -25°C ~ +60°C	Weight 1.35KG	Wiring Mode E1
---	------------------------------	-------------------------	-----------------------	--	------------------	-------------------

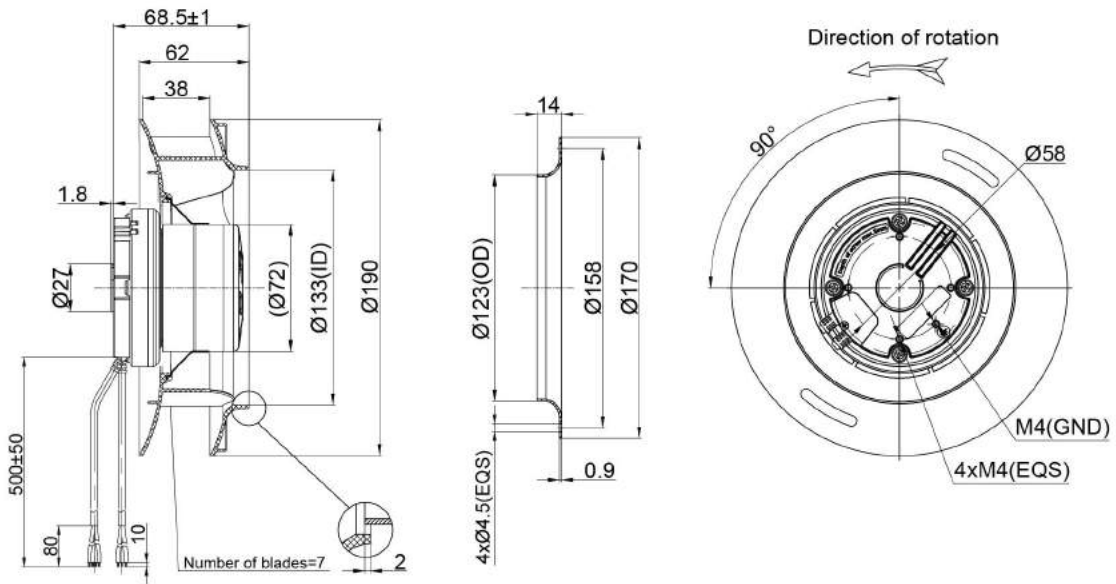

Model	Motor	Bearing System	Rated Voltage	Frequency	Rated Current	Rated Power	Rated Speed	Air Flow	Air Pressure	Sound Level
Part No.	Type	B/S	VAC	Hz	A	W	RPM	M ³ /H	Pa	dB(A)
PB3N190B2E-RZ0	BE72EC	BALL	230	50/60	0.4	52	2940	540	450	65

EC Centrifugal Fan backward Curved Ø190x68.5mm

Backward Curved Centrifugal Fans

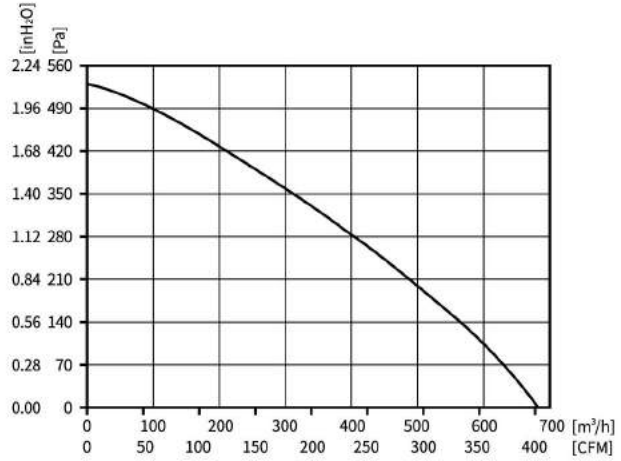

Motor Type EC BRUSHLESS EXTERNAL ROTOR MOTOR	Speed Control 0-10VDC/PWM	Protection Type IP55	Insulation Class B	Operating Temperature -25°C ~ +60°C	Weight 1.35KG	Wiring Mode E1
---	------------------------------	-------------------------	-----------------------	--	------------------	-------------------

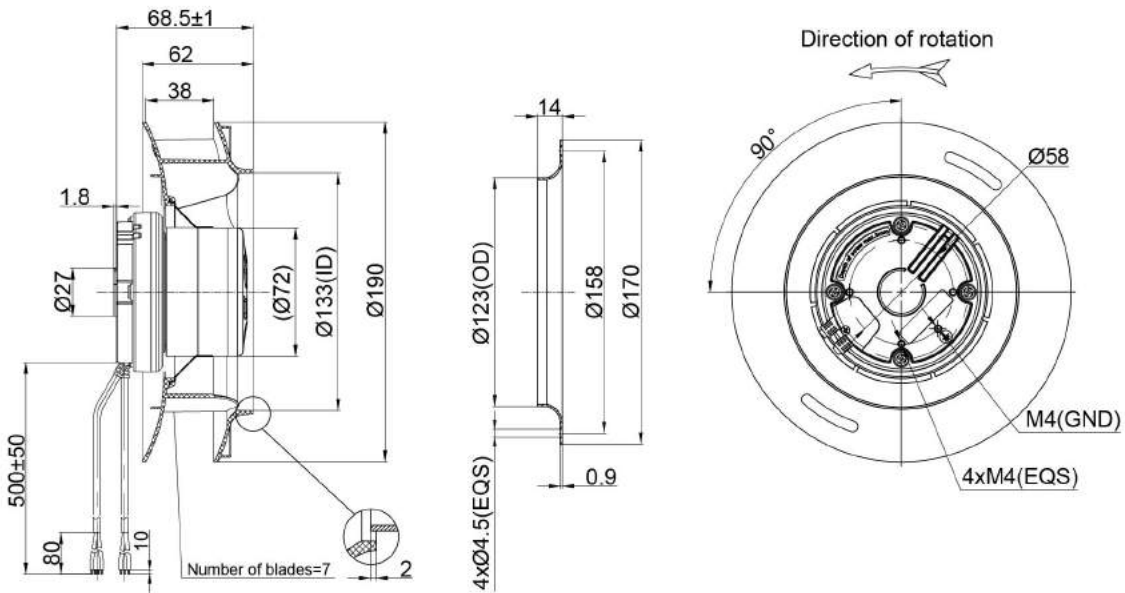

Model	Motor	Bearing System	Rated Voltage	Frequency	Rated Current	Rated Power	Rated Speed	Air Flow	Air Pressure	Sound Level
Part No.	Type	B/S	VAC	Hz	A	W	RPM	M ³ /H	Pa	dB(A)
PB3N190B2E-RZ1	BE72EC	BALL	230	50/60	0.6	70	3300	685	530	68

EC Centrifugal Fan Backward Curved Ø190x68.5mm

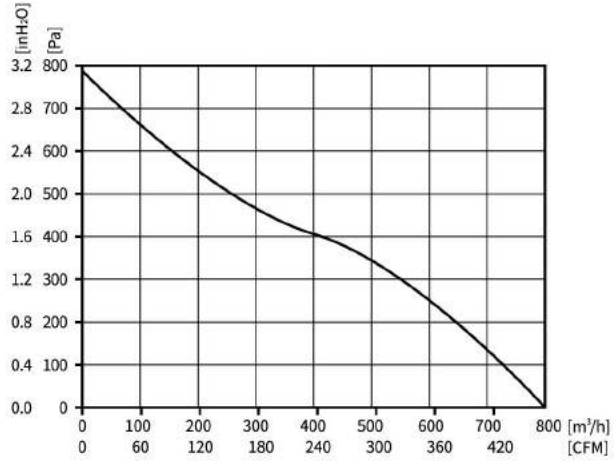

Backward Curved Centrifugal Fans

Motor Type EC BRUSHLESS EXTERNAL ROTOR MOTOR	Speed Control 0-10VDC/PWM	Protection Type IP55	Insulation Class B	Operating Temperature -25°C ~ +60°C	Weight 1.35KG	Wiring Mode E1
---	------------------------------	-------------------------	-----------------------	--	------------------	-------------------

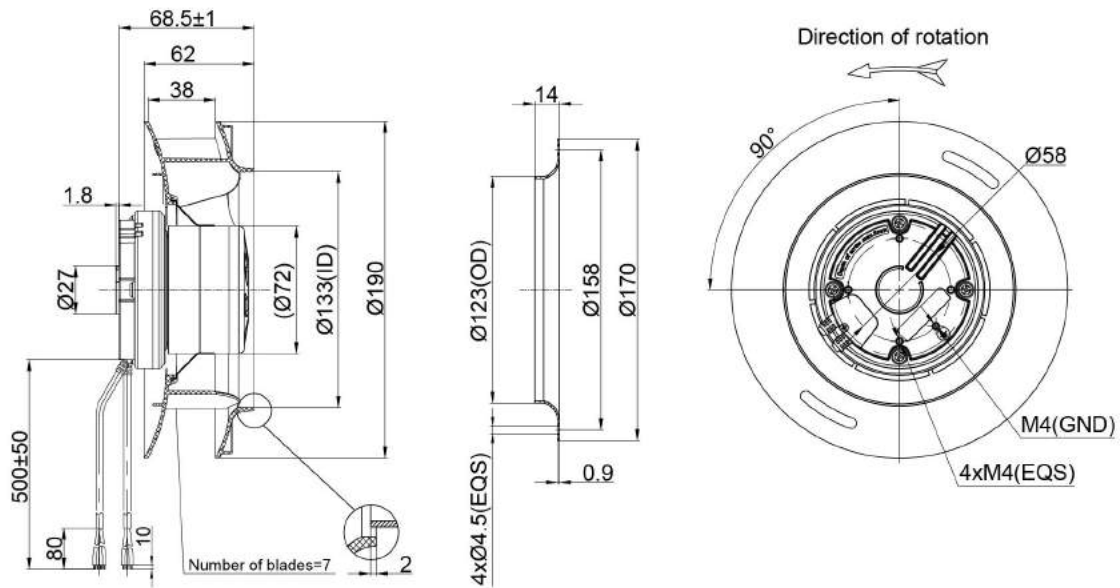

Model	Motor	Bearing System	Rated Voltage	Frequency	Rated Current	Rated Power	Rated Speed	Air Flow	Air Pressure	Sound Level
Part No.	Type	B/S	VAC	Hz	A	W	RPM	M ³ /H	Pa	dB(A)
PB3N190B2E-RZ2	BE72EC	BALL	230	50/60	0.9	110	3700	800	790	70

EC Centrifugal Fan backward Curved Ø190x68.5mm

Backward Curved Centrifugal Fans

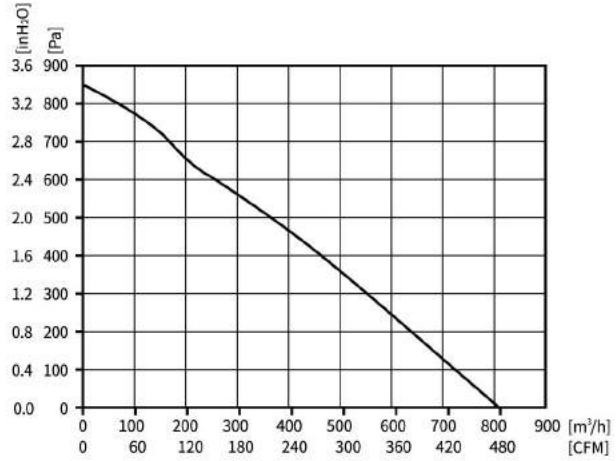

Motor Type EC BRUSHLESS EXTERNAL ROTOR MOTOR	Speed Control 0-10VDC/PWM	Protection Type IP55	Insulation Class B	Operating Temperature -25°C ~ +60°C	Weight 1.45KG	Wiring Mode E1
---	------------------------------	-------------------------	-----------------------	--	------------------	-------------------

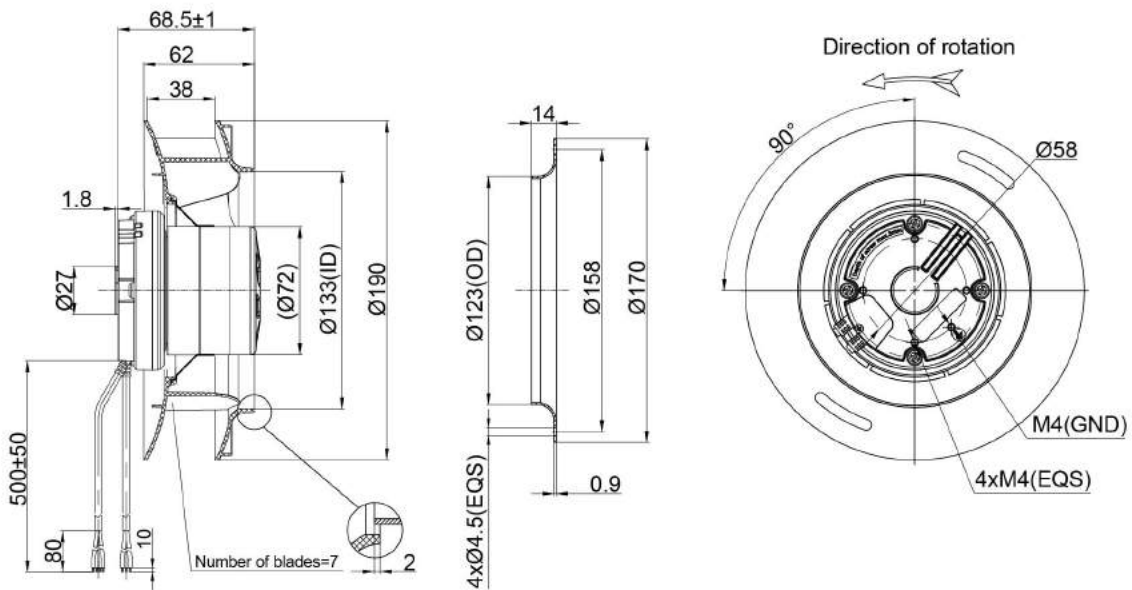

Model	Motor	Bearing System	Rated Voltage	Frequency	Rated Current	Rated Power	Rated Speed	Air Flow	Air Pressure	Sound Level
Part No.	Type	B/S	VAC	Hz	A	W	RPM	M³/H	Pa	dB(A)
PB3N190B2E-SZ0	BE72EC	BALL	230	50/60	0.8	110	3800	810	850	71

EC Centrifugal Fan Backward Curved Ø190x88mm

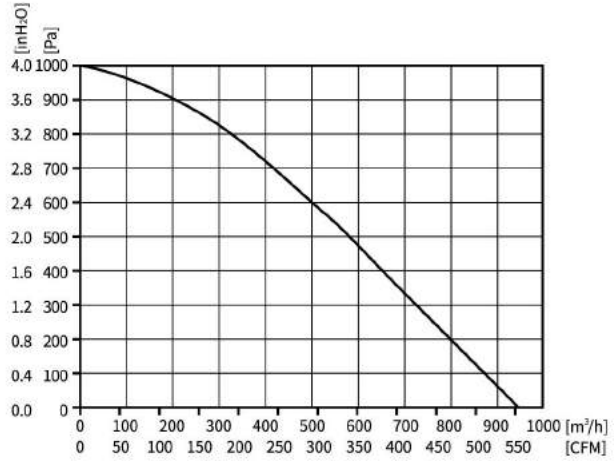

Backward Curved Centrifugal Fans

Motor Type EC BRUSHLESS EXTERNAL ROTOR MOTOR	Speed Control 0-10VDC/PWM	Protection Type IP55	Insulation Class B	Operating Temperature -25°C ~ +60°C	Weight 1.85KG	Wiring Mode E1
---	------------------------------	-------------------------	-----------------------	--	------------------	-------------------

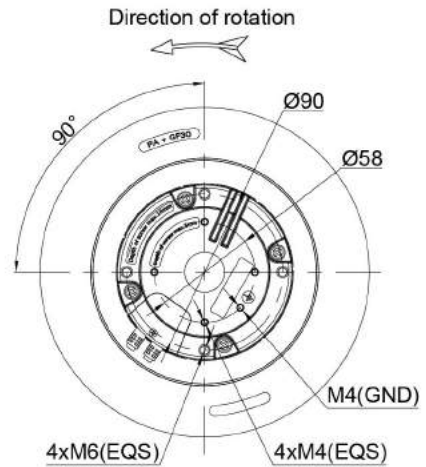
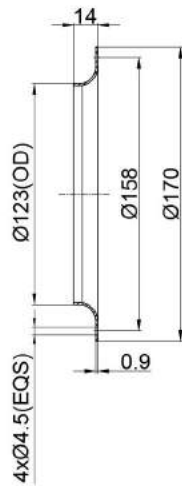
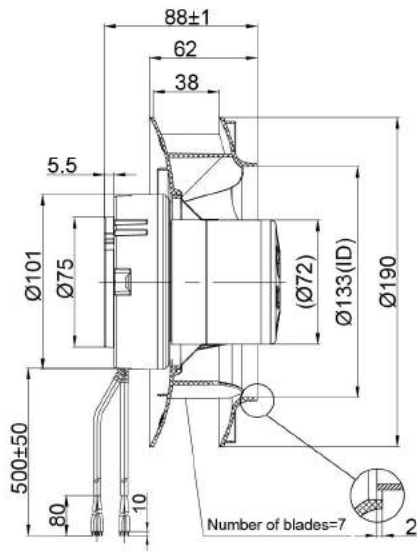

Model	Motor	Bearing System	Rated Voltage	Frequency	Rated Current	Rated Power	Rated Speed	Air Flow	Air Pressure	Sound Level
Part No.	Type	B/S	VAC	Hz	A	W	RPM	M ³ /H	Pa	dB(A)
PB3N190B2E-TZ0	BE72EC	BALL	230	50/60	1.2	170	4550	945	1000	72

EC Centrifugal Fan backward Curved Ø220x90mm

Backward Curved Centrifugal Fans

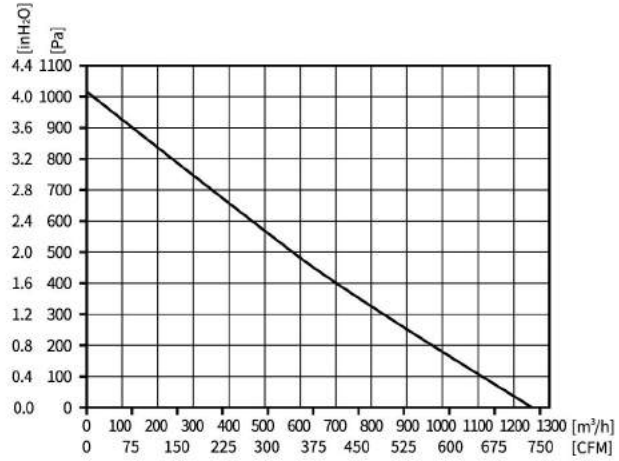

Motor Type EC BRUSHLESS EXTERNAL ROTOR MOTOR	Speed Control 0-10VDC/PWM	Protection Type IP55	Insulation Class B	Operating Temperature -25°C ~ +60°C	Weight 2.45KG	Wiring Mode E1
---	------------------------------	-------------------------	-----------------------	--	------------------	-------------------

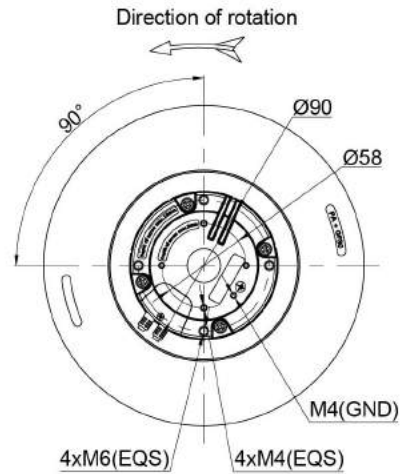
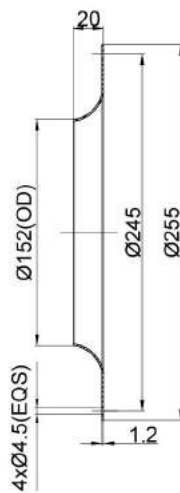
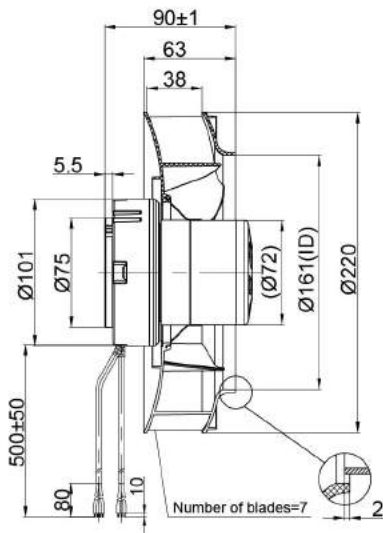

Model	Motor	Bearing System	Rated Voltage	Frequency	Rated Current	Rated Power	Rated Speed	Air Flow	Air Pressure	Sound Level
Part No.	Type	B/S	VAC	Hz	A	W	RPM	M ³ /H	Pa	dB(A)
PB3N220B2E-TZ0	BE72EC	BALL	230	50/60	1.2	170	3500	1255	1010	70

EC Centrifugal Fan Backward Curved Ø225x99mm

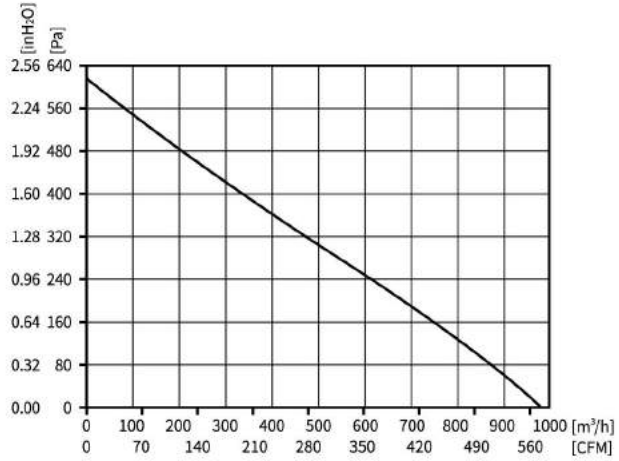

Backward Curved Centrifugal Fans

Motor Type EC BRUSHLESS EXTERNAL ROTOR MOTOR	Speed Control 0-10VDC/PWM	Protection Type IP55	Insulation Class B	Operating Temperature -25°C ~ +60°C	Weight 1.52KG	Wiring Mode E1
---	------------------------------	-------------------------	-----------------------	--	------------------	-------------------

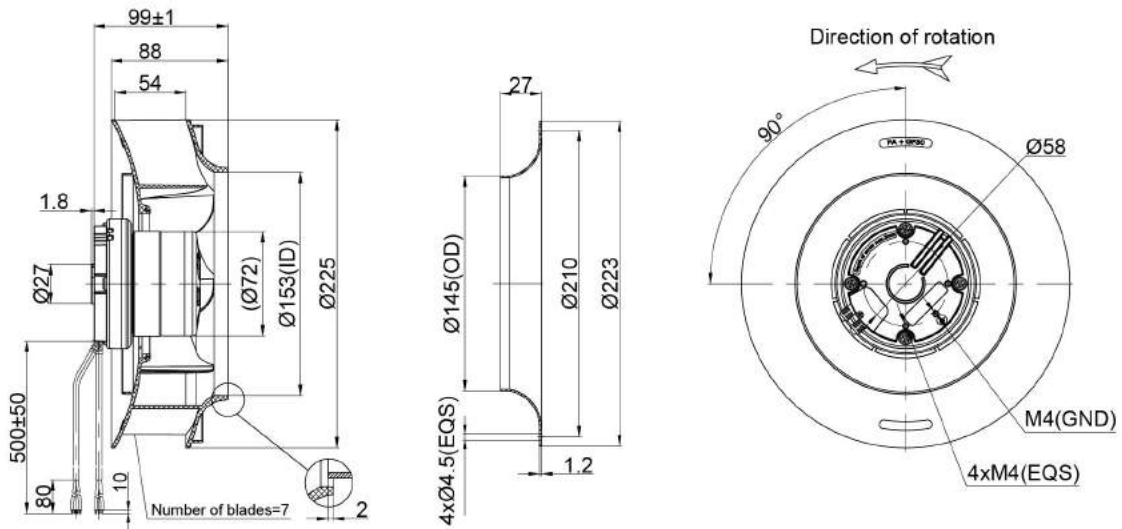

Model	Motor	Bearing System	Rated Voltage	Frequency	Rated Current	Rated Power	Rated Speed	Air Flow	Air Pressure	Sound Level
Part No.	Type	B/S	VAC	Hz	A	W	RPM	M ³ /H	Pa	dB(A)
PB3N225B2E-RG0	BE72EC	BALL	230	50/60	0.6	85	2300	975	620	65

EC Centrifugal Fan backward Curved Ø225x99mm

Backward Curved Centrifugal Fans

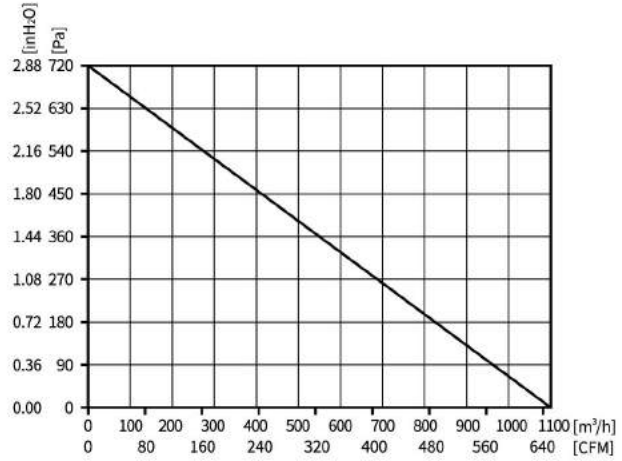

Motor Type EC BRUSHLESS EXTERNAL ROTOR MOTOR	Speed Control 0-10VDC/PWM	Protection Type IP55	Insulation Class B	Operating Temperature -25°C ~ +60°C	Weight 1.52KG	Wiring Mode E2
---	------------------------------	-------------------------	-----------------------	--	------------------	-------------------

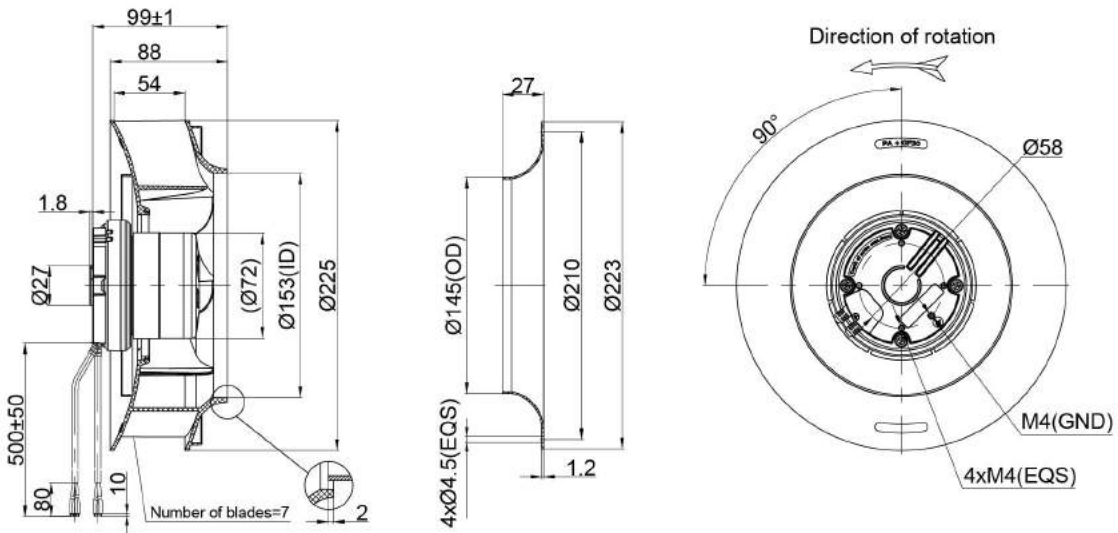

Model	Motor	Bearing System	Rated Voltage	Frequency	Rated Current	Rated Power	Rated Speed	Air Flow	Air Pressure	Sound Level
Part No.	Type	B/S	VAC	Hz	A	W	RPM	M³/H	Pa	dB(A)
PB3N225B2E-RG1	BE72EC	BALL	230	50/60	0.75	100	2450	1100	720	66

EC Centrifugal Fan Backward Curved Ø225x99mm

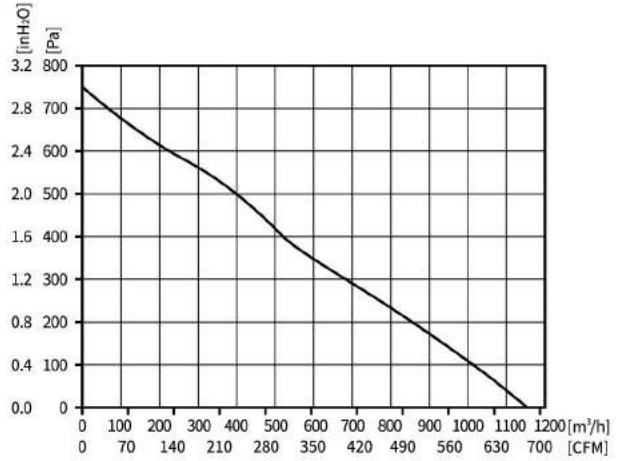

Backward Curved Centrifugal Fans

Motor Type EC BRUSHLESS EXTERNAL ROTOR MOTOR	Speed Control 0-10VDC/PWM	Protection Type IP55	Insulation Class B	Operating Temperature -25°C ~ +60°C	Weight 1.65KG	Wiring Mode E1
---	------------------------------	-------------------------	-----------------------	--	------------------	-------------------

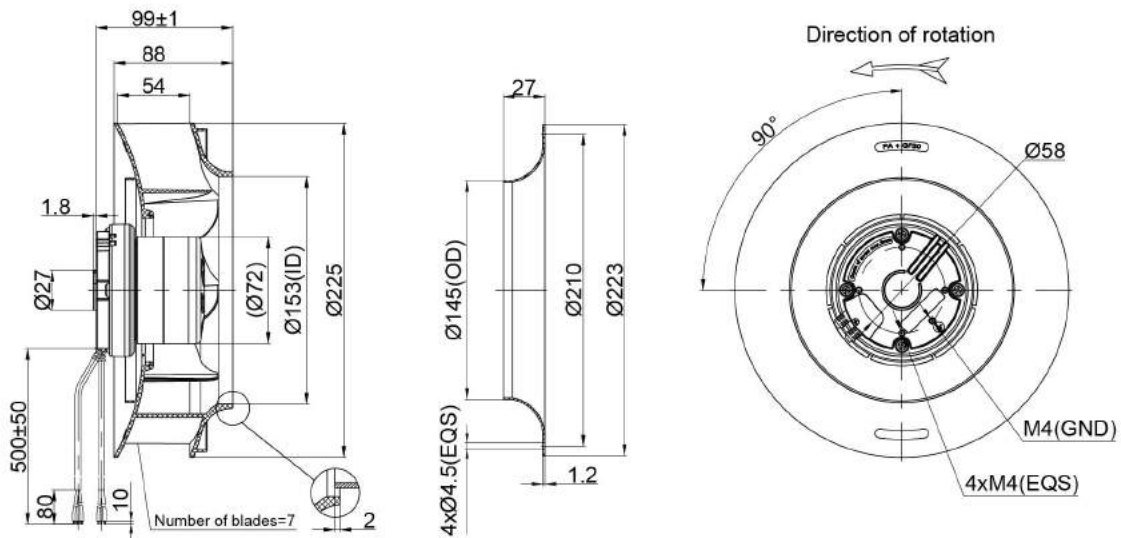

Model	Motor	Bearing System	Rated Voltage	Frequency	Rated Current	Rated Power	Rated Speed	Air Flow	Air Pressure	Sound Level
Part No.	Type	B/S	VAC	Hz	A	W	RPM	M³/H	Pa	dB(A)
PB3N225B2E-SG0	BE72EC	BALL	230	50/60	0.8	110	2600	1150	750	68

EC Centrifugal Fan backward Curved Ø225x99mm

Backward Curved Centrifugal Fans

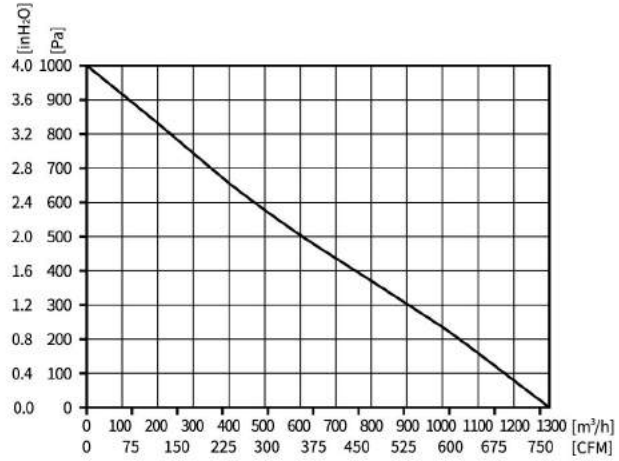

Motor Type EC BRUSHLESS EXTERNAL ROTOR MOTOR	Speed Control 0-10VDC/PWM	Protection Type IP55	Insulation Class B	Operating Temperature -25°C ~ +60°C	Weight 2.47KG	Wiring Mode E1
---	------------------------------	-------------------------	-----------------------	--	------------------	-------------------

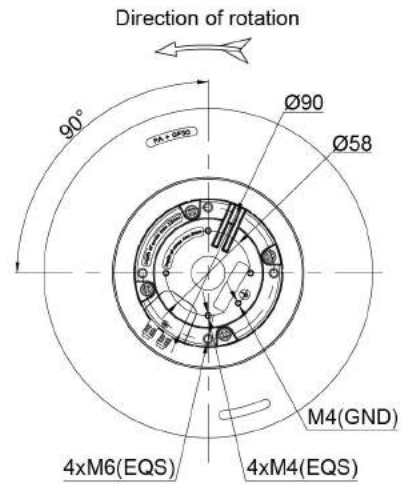
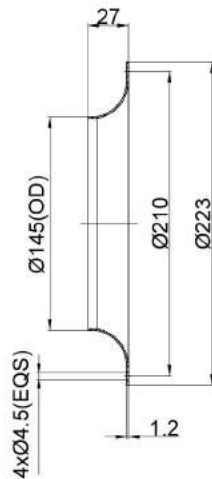
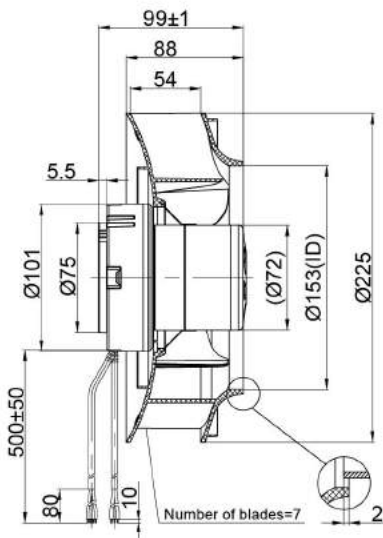

Model	Motor	Bearing System	Rated Voltage	Frequency	Rated Current	Rated Power	Rated Speed	Air Flow	Air Pressure	Sound Level
Part No.	Type	B/S	VAC	Hz	A	W	RPM	M ³ /H	Pa	dB(A)
PB3N225B2E-TG0	BE72EC	BALL	230	50/60	1.2	170	3200	1300	1000	71

EC Centrifugal Fan Backward Curved Ø225x99mm

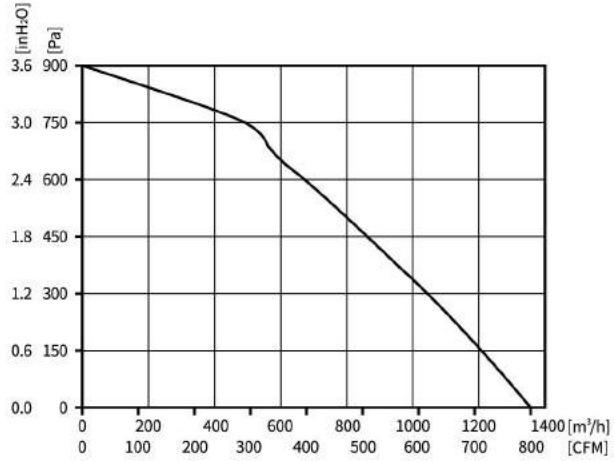

Backward Curved Centrifugal Fans

Motor Type EC BRUSHLESS EXTERNAL ROTOR MOTOR	Speed Control 0-10VDC/PWM	Protection Type IP55	Insulation Class B	Operating Temperature -25°C ~ +60°C	Weight 3.1KG	Wiring Mode E2
---	------------------------------	-------------------------	-----------------------	--	-----------------	-------------------

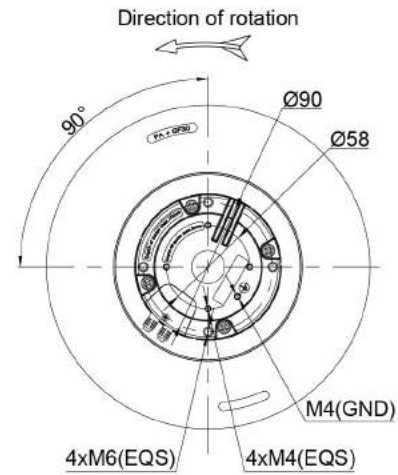
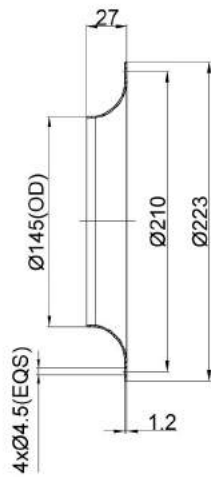
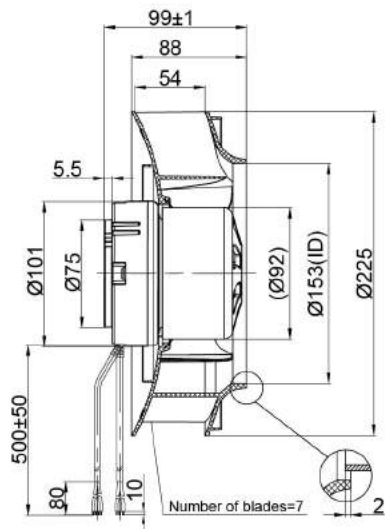

Model	Motor	Bearing System	Rated Voltage	Frequency	Rated Current	Rated Power	Rated Speed	Air Flow	Air Pressure	Sound Level
Part No.	Type	B/S	VAC	Hz	A	W	RPM	M ³ /H	Pa	dB(A)
PB3N225B2E-MG0	BE92EC	BALL	230	50/60	1.6	220	3500	1350	900	72

EC Centrifugal Fan backward Curved Ø250x99mm

Backward Curved Centrifugal Fans

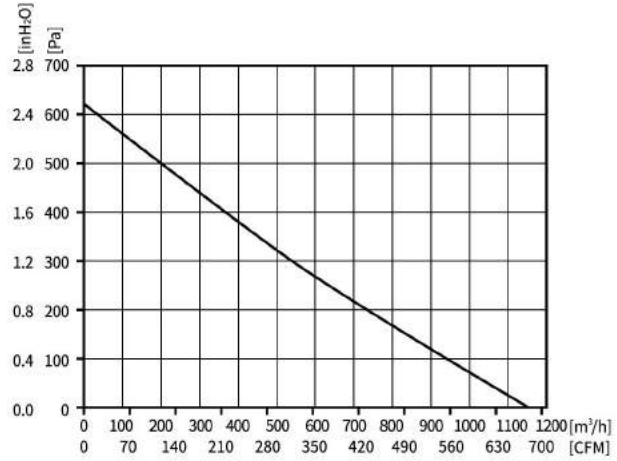

Motor Type EC BRUSHLESS EXTERNAL ROTOR MOTOR	Speed Control 0-10VDC/PWM	Protection Type IP55	Insulation Class B	Operating Temperature -25°C ~ +60°C	Weight 1.72KG	Wiring Mode E1
---	------------------------------	-------------------------	-----------------------	--	------------------	-------------------

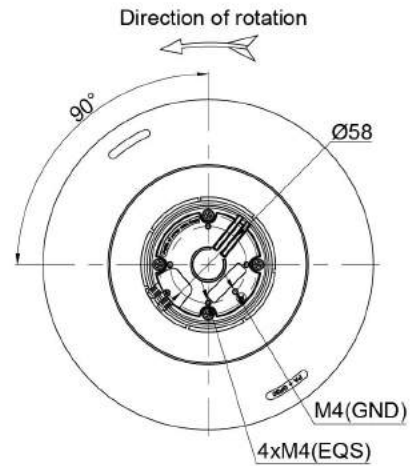
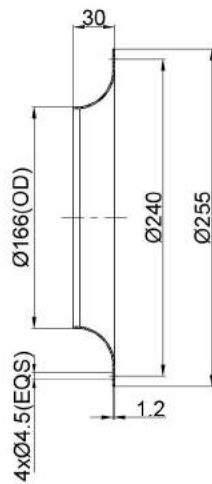
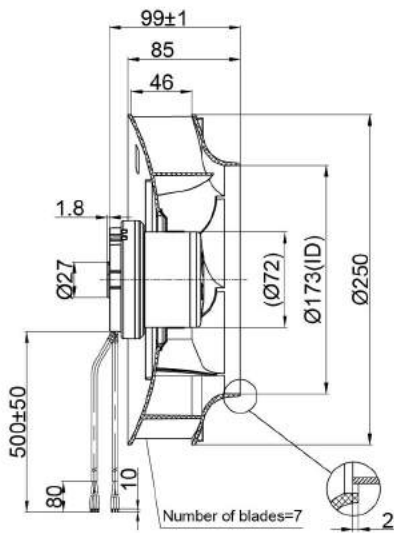

Model	Motor	Bearing System	Rated Voltage	Frequency	Rated Current	Rated Power	Rated Speed	Air Flow	Air Pressure	Sound Level
Part No.	Type	B/S	VAC	Hz	A	W	RPM	M ³ /H	Pa	dB(A)
PB3N250B2E-RZ0	BE72EC	BALL	230	50/60	0.65	85	2100	1150	610	62

EC Centrifugal Fan Backward Curved Ø250x99mm

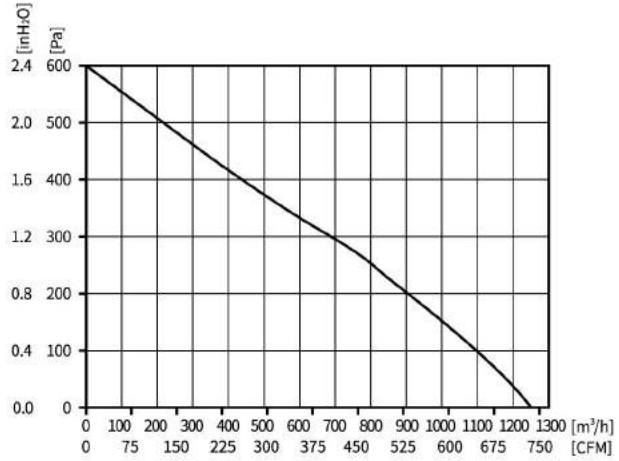

Backward Curved Centrifugal Fans

Motor Type EC BRUSHLESS EXTERNAL ROTOR MOTOR	Speed Control 0-10VDC/PWM	Protection Type IP55	Insulation Class B	Operating Temperature -25°C~+60°C	Weight 1.82KG	Wiring Mode E1
---	------------------------------	-------------------------	-----------------------	--------------------------------------	------------------	-------------------

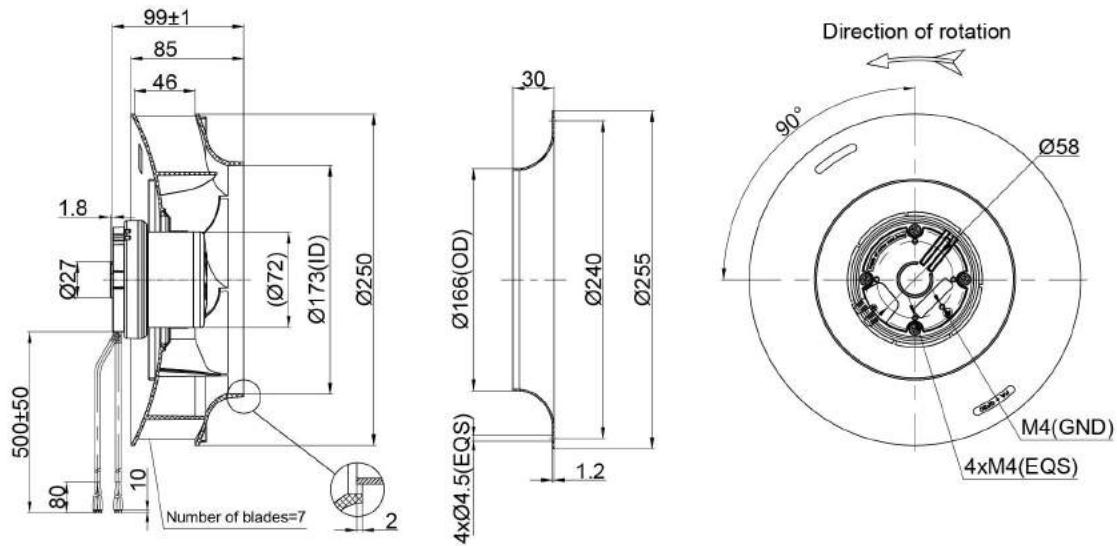

Model	Motor	Bearing System	Rated Voltage	Frequency	Rated Current	Rated Power	Rated Speed	Air Flow	Air Pressure	Sound Level
Part No.	Type	B/S	VAC	Hz	A	W	RPM	M³/H	Pa	dB(A)
PB3N250B2E-SZ0	BE72EC	BALL	230	50/60	0.85	115	2350	1250	600	68

EC Centrifugal Fan backward Curved Ø250x99mm

Backward Curved Centrifugal Fans

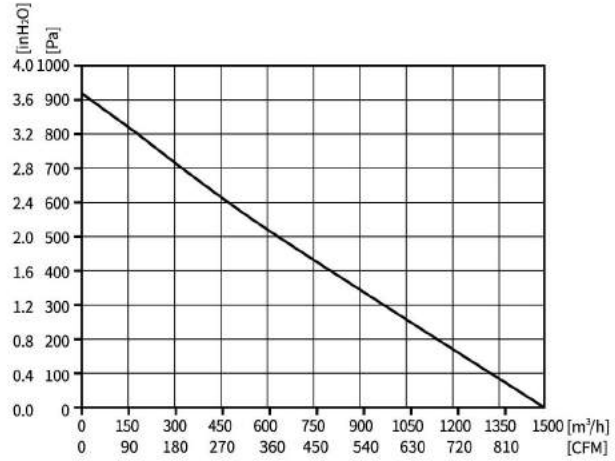

Motor Type EC BRUSHLESS EXTERNAL ROTOR MOTOR	Speed Control 0-10VDC/PWM	Protection Type IP55	Insulation Class B	Operating Temperature -25°C ~ +60°C	Weight 2.42KG	Wiring Mode E1
---	------------------------------	-------------------------	-----------------------	--	------------------	-------------------

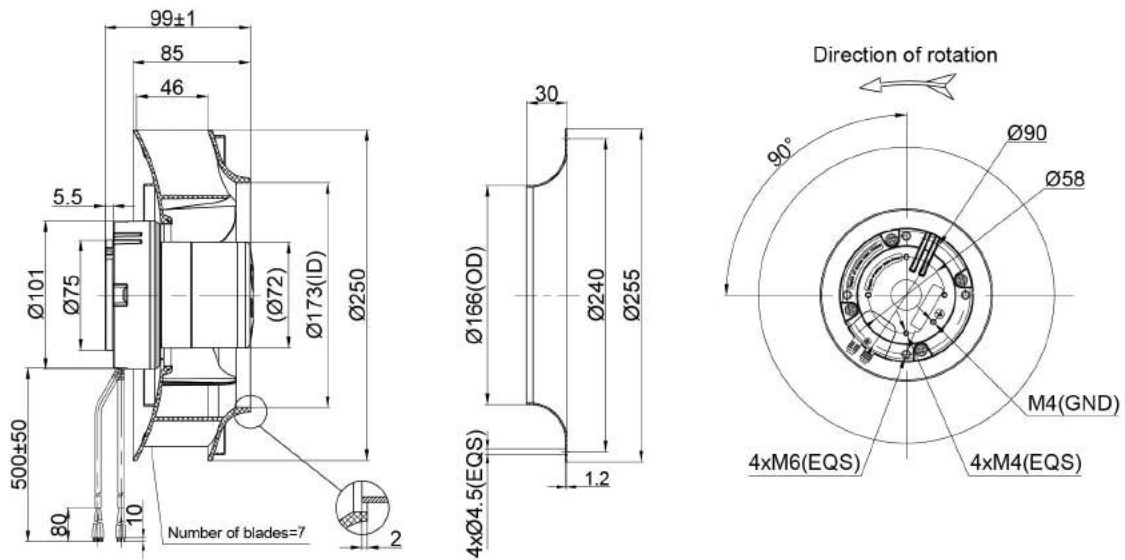

Model	Motor	Bearing System	Rated Voltage	Frequency	Rated Current	Rated Power	Rated Speed	Air Flow	Air Pressure	Sound Level
Part No.	Type	B/S	VAC	Hz	A	W	RPM	M ³ /H	Pa	dB(A)
PB3N250B2E-TZ0	BE72EC	BALL	230	50/60	1.2	170	2750	1500	915	71

EC Centrifugal Fan Backward Curved Ø250x99mm

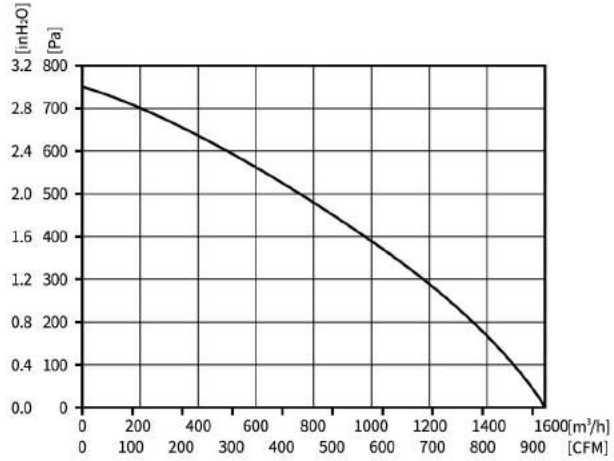

Backward Curved Centrifugal Fans

Motor Type EC BRUSHLESS EXTERNAL ROTOR MOTOR	Speed Control 0-10VDC/PWM	Protection Type IP55	Insulation Class B	Operating Temperature -25°C ~ +60°C	Weight 3.42KG	Wiring Mode E2
---	------------------------------	-------------------------	-----------------------	--	------------------	-------------------

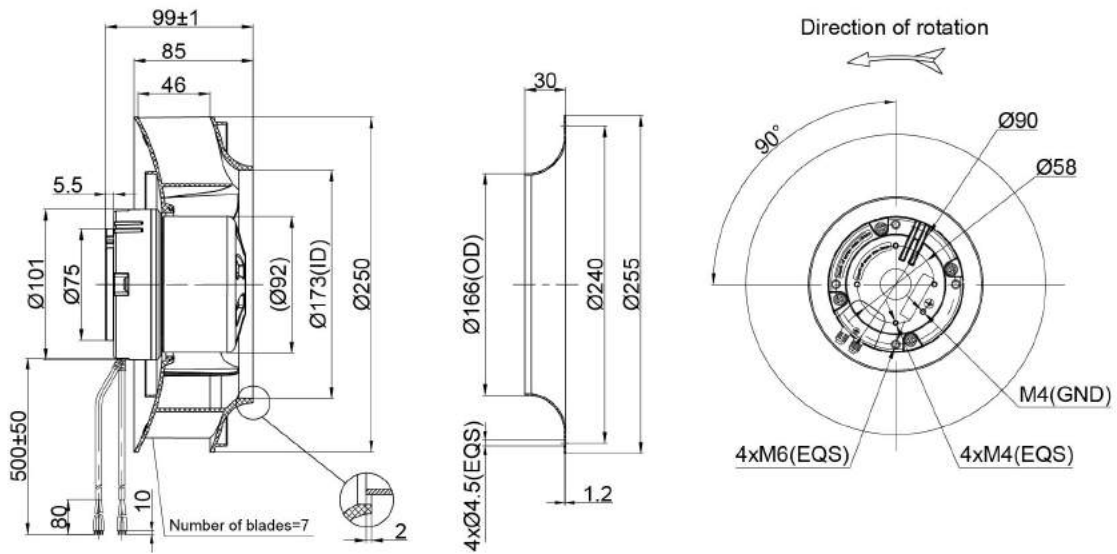

Model	Motor	Bearing System	Rated Voltage	Frequency	Rated Current	Rated Power	Rated Speed	Air Flow	Air Pressure	Sound Level
Part No.	Type	B/S	VAC	Hz	A	W	RPM	M ³ /H	Pa	dB(A)
PB3N250B2E-MZ0	BE92EC	BALL	230	50/60	1.6	220	3100	1600	750	72

EC Centrifugal Fan backward Curved Ø250x210.5mm

Backward Curved Centrifugal Fans

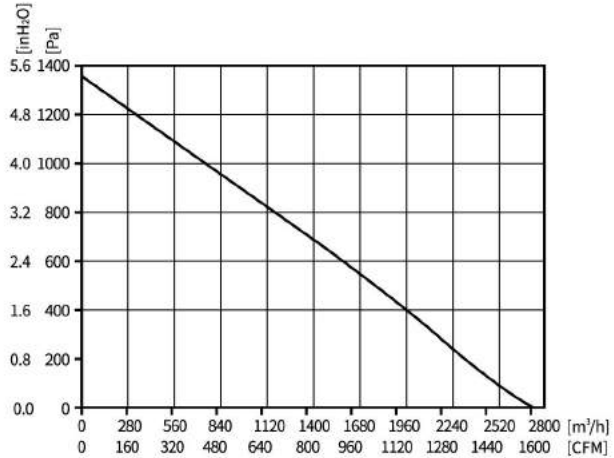

Motor Type EC BRUSHLESS EXTERNAL ROTOR MOTOR	Speed Control 0-10VDC/PWM	Protection Type IP55	Insulation Class F	Operating Temperature -25°C ~ +60°C	Weight 5.91KG	Wiring Mode E3
---	------------------------------	-------------------------	-----------------------	--	------------------	-------------------

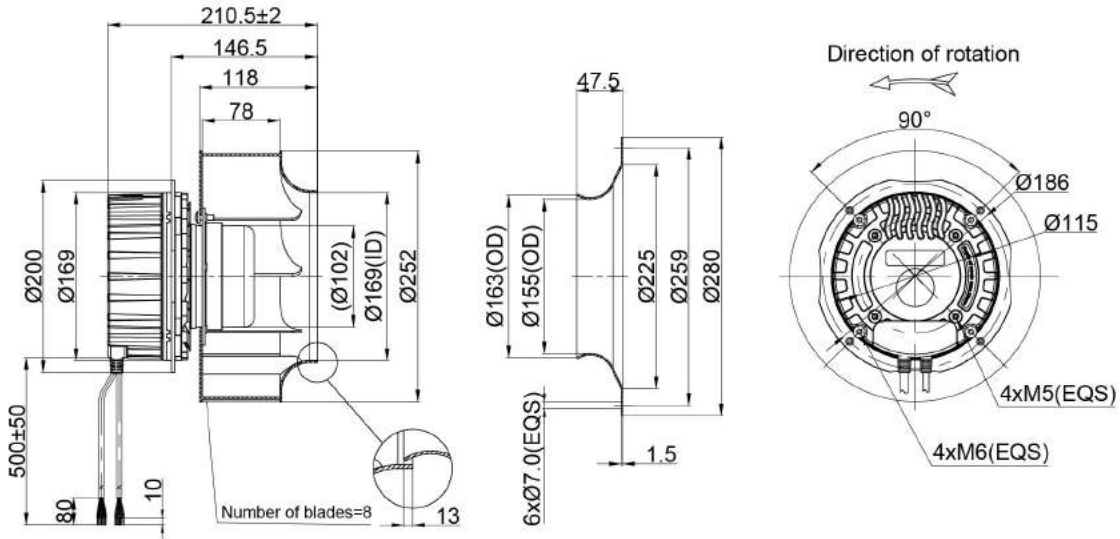

Model	Motor	Bearing System	Rated Voltage	Frequency	Rated Current	Rated Power	Rated Speed	Air Flow	Air Pressure	Sound Level
Part No.	Type	B/S	VAC	Hz	A	W	RPM	M ³ /H	Pa	dB(A)
PB3N250B2E-YZ5	BE102EC	BALL	230	50/60	2.5	550	3600	2750	1330	85

EC Centrifugal Fan Backward Curved Ø250x210.5mm

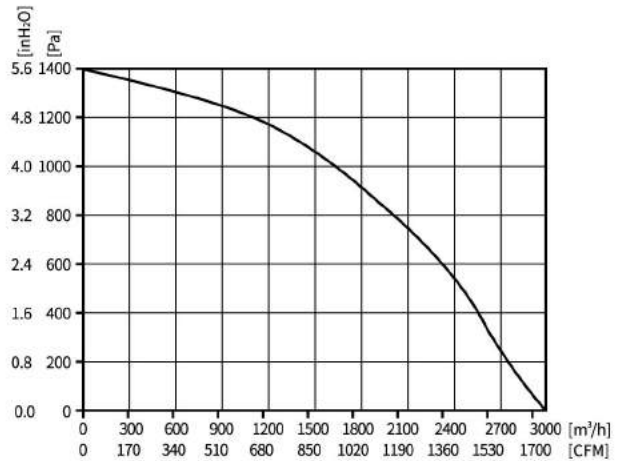

Backward Curved Centrifugal Fans

Motor Type EC BRUSHLESS EXTERNAL ROTOR MOTOR	Speed Control 0-10VDC/PWM	Protection Type IP55	Insulation Class F	Operating Temperature -25°C ~ +60°C	Weight 5.91KG	Wiring Mode E4
---	------------------------------	-------------------------	-----------------------	--	------------------	-------------------

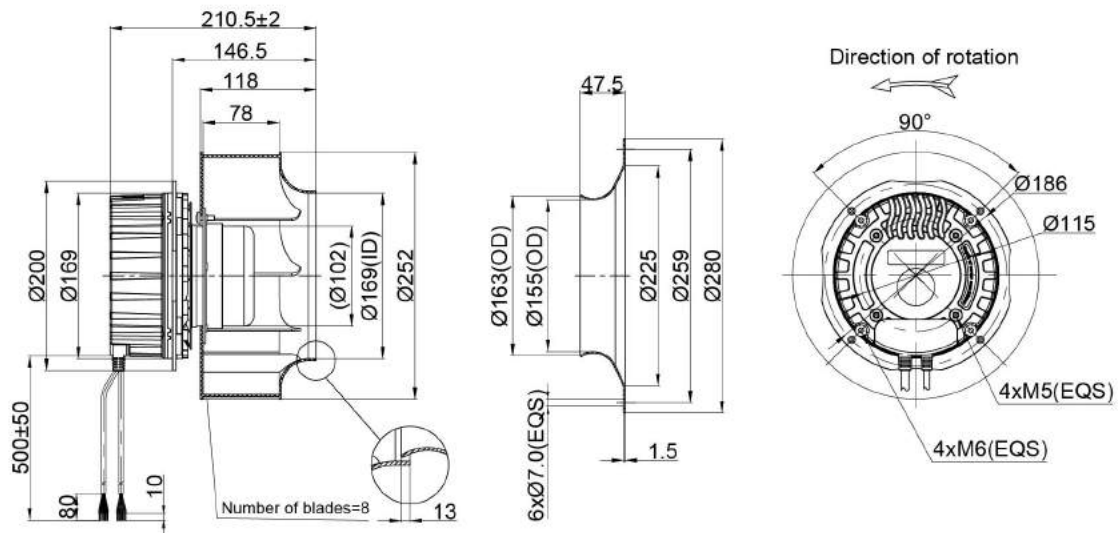

Model	Motor	Bearing System	Rated Voltage	Frequency	Rated Current	Rated Power	Rated Speed	Air Flow	Air Pressure	Sound Level
Part No.	Type	B/S	VAC	Hz	A	W	RPM	M³/H	Pa	dB(A)
PB3N250B4E-YZ5	BE102EC	BALL	380	50/60	1.17	750	4100	3000	1400	91

EC Centrifugal Fan backward Curved Ø280x119mm

Backward Curved Centrifugal Fans

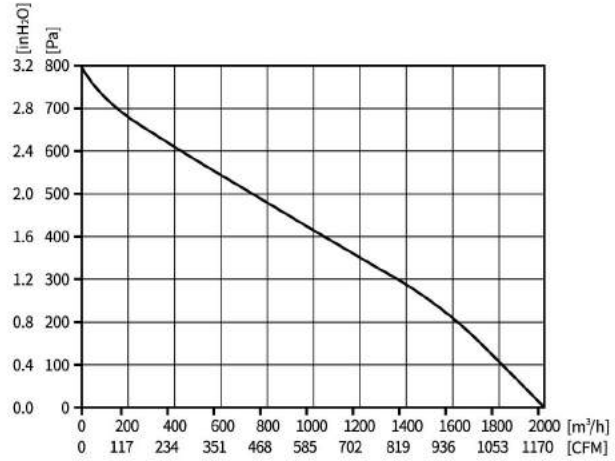

Motor Type EC BRUSHLESS EXTERNAL ROTOR MOTOR	Speed Control 0-10VDC/PWM	Protection Type IP55	Insulation Class B	Operating Temperature -25°C ~ +60°C	Weight 3.67KG	Wiring Mode E2
---	------------------------------	-------------------------	-----------------------	--	------------------	-------------------

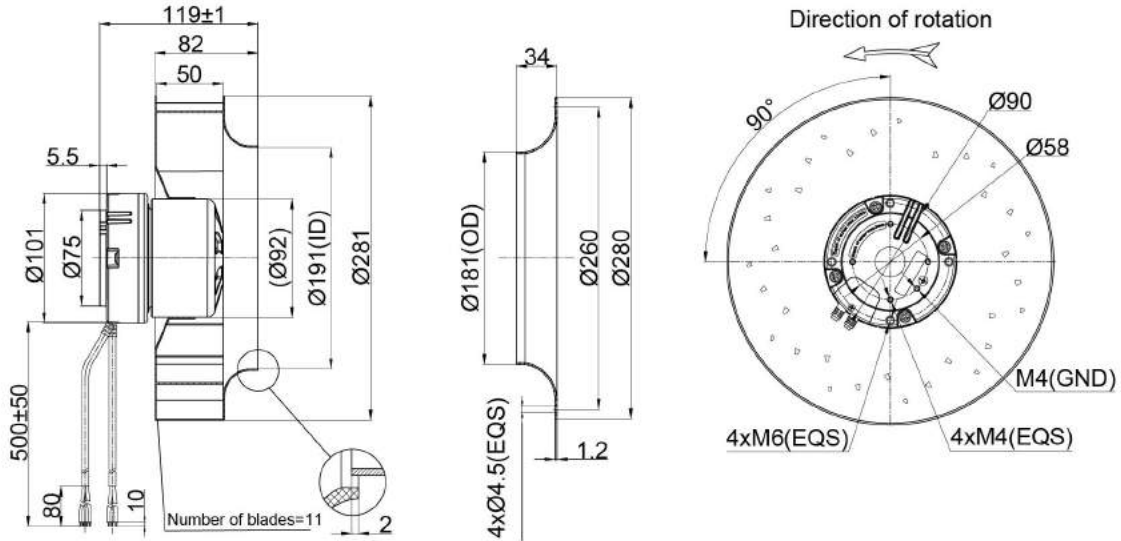

Model	Motor	Bearing System	Rated Voltage	Frequency	Rated Current	Rated Power	Rated Speed	Air Flow	Air Pressure	Sound Level
Part No.	Type	B/S	VAC	Hz	A	W	RPM	M ³ /H	Pa	dB(A)
PB3N280B2E-MZ0	BE92EC	BALL	230	50/60	1.5	210	2600	2000	800	70

EC Centrifugal Fan Backward Curved Ø280x225.5mm

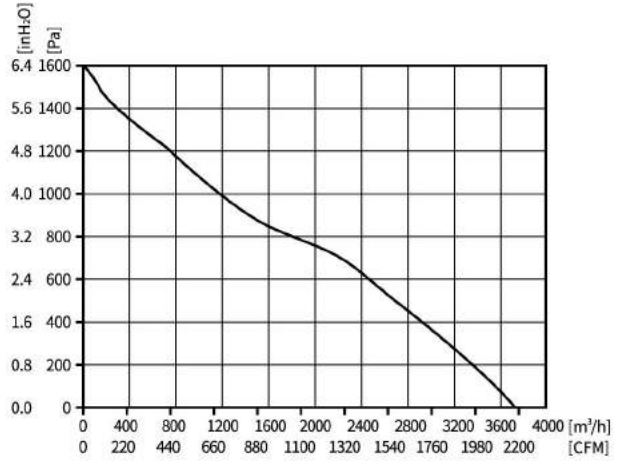

Backward Curved Centrifugal Fans

Motor Type EC BRUSHLESS EXTERNAL ROTOR MOTOR	Speed Control 0-10VDC/PWM	Protection Type IP55	Insulation Class F	Operating Temperature -25°C ~ +60°C	Weight 6.4KG	Wiring Mode E3
---	------------------------------	-------------------------	-----------------------	--	-----------------	-------------------

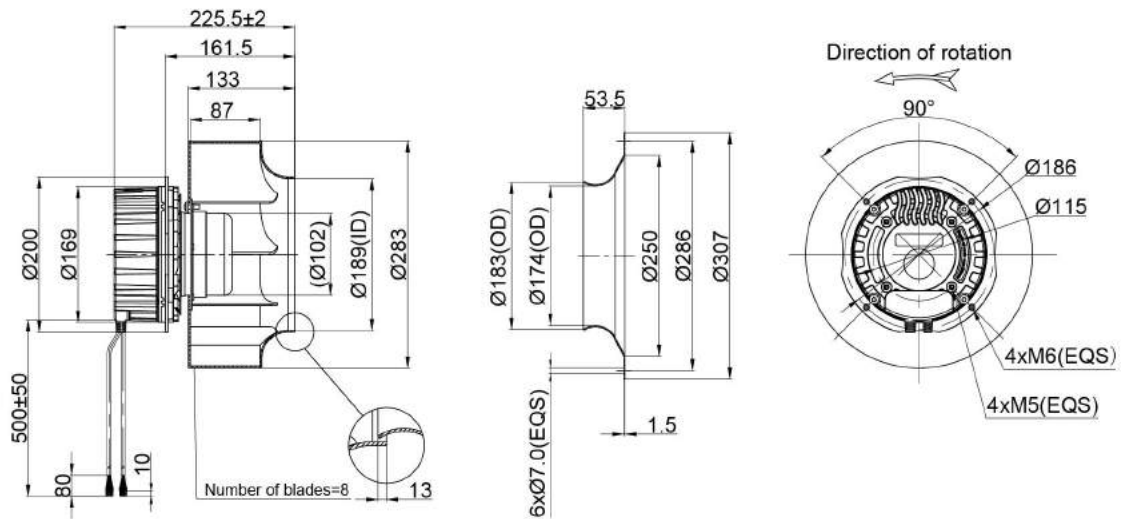

Model	Motor	Bearing System	Rated Voltage	Frequency	Rated Current	Rated Power	Rated Speed	Air Flow	Air Pressure	Sound Level
Part No.	Type	B/S	VAC	Hz	A	W	RPM	M ³ /H	Pa	dB(A)
PB3N280B2E-YZ5	BE102EC	BALL	230	50/60	3.1	700	3300	3720	1600	85

EC Centrifugal Fan backward Curved Ø280x225.5mm

Backward Curved Centrifugal Fans

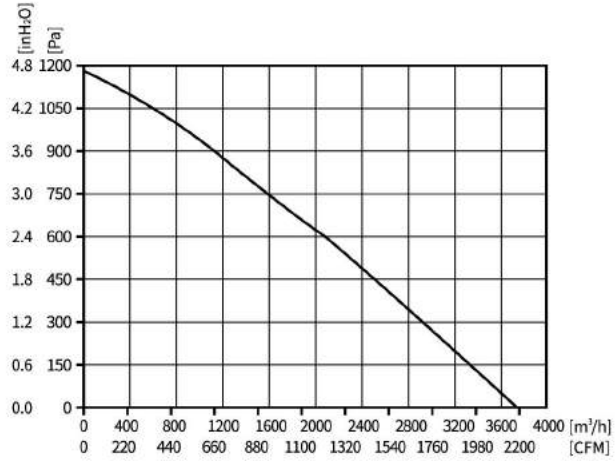

Motor Type EC BRUSHLESS EXTERNAL ROTOR MOTOR	Speed Control 0-10VDC/PWM	Protection Type IP55	Insulation Class F	Operating Temperature -25°C ~ +60°C	Weight 6.4KG	Wiring Mode E4
---	------------------------------	-------------------------	-----------------------	--	-----------------	-------------------

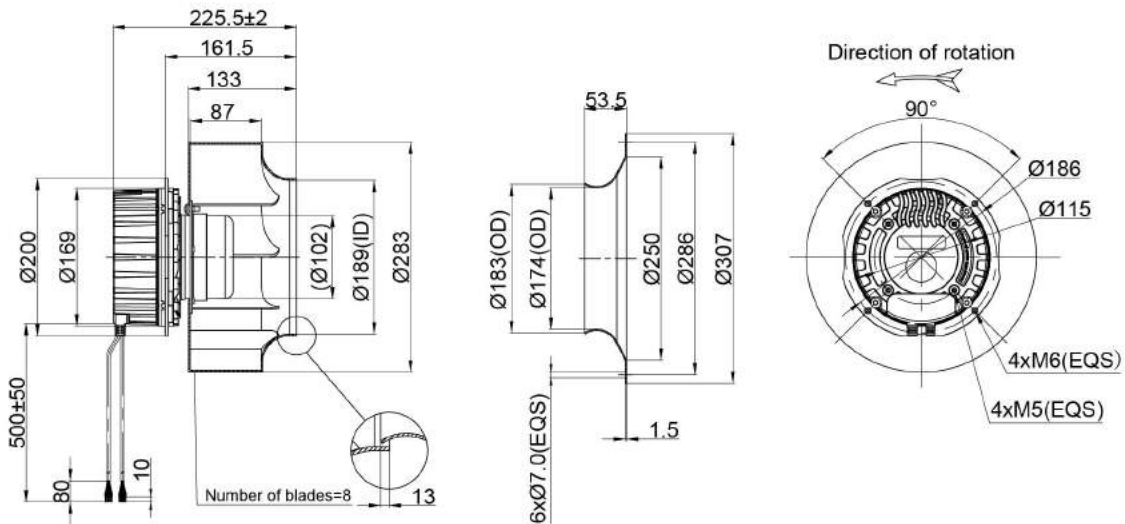

Model	Motor	Bearing System	Rated Voltage	Frequency	Rated Current	Rated Power	Rated Speed	Air Flow	Air Pressure	Sound Level
Part No.	Type	B/S	VAC	Hz	A	W	RPM	M ³ /H	Pa	dB(A)
PB3N280B4E-YZ5	BE102EC	BALL	380	50/60	1.26	800	3400	3700	1180	93

EC Centrifugal Fan Backward Curved Ø310x133.5mm

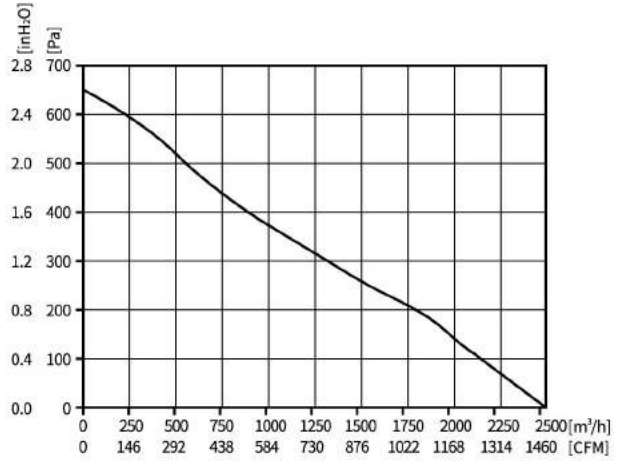

Backward Curved Centrifugal Fans

Motor Type EC BRUSHLESS EXTERNAL ROTOR MOTOR	Speed Control 0-10VDC/PWM	Protection Type IP55	Insulation Class B	Operating Temperature -25°C~+60°C	Weight 3.94KG	Wiring Mode E2
---	------------------------------	-------------------------	-----------------------	--------------------------------------	------------------	-------------------

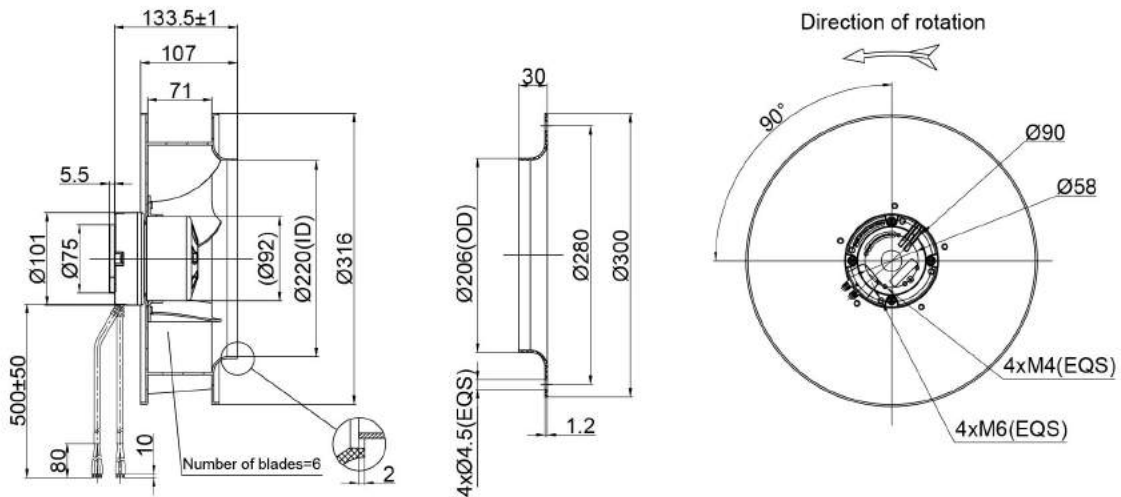

Model	Motor	Bearing System	Rated Voltage	Frequency	Rated Current	Rated Power	Rated Speed	Air Flow	Air Pressure	Sound Level
Part No.	Type	B/S	VAC	Hz	A	W	RPM	M³/H	Pa	dB(A)
PB3N310B2E-MZ0	BE92EC	BALL	230	50/60	1.55	220	2100	2500	650	66

EC Centrifugal Fan backward Curved Ø310x221mm

Backward Curved Centrifugal Fans

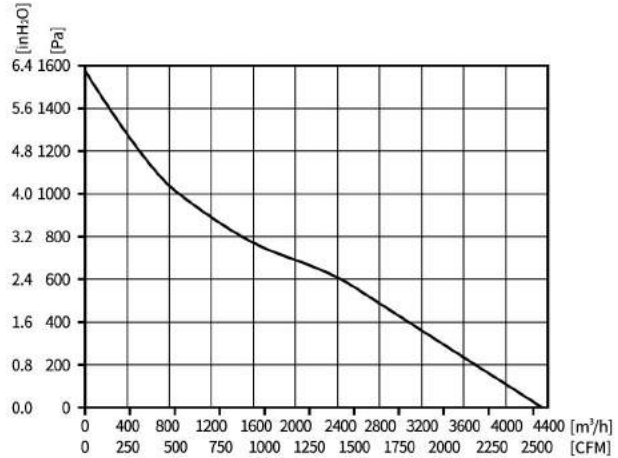

Motor Type EC BRUSHLESS EXTERNAL ROTOR MOTOR	Speed Control 0-10VDC/PWM	Protection Type IP55	Insulation Class F	Operating Temperature -25°C ~ +60°C	Weight 6.77KG	Wiring Mode E3
---	------------------------------	-------------------------	-----------------------	--	------------------	-------------------

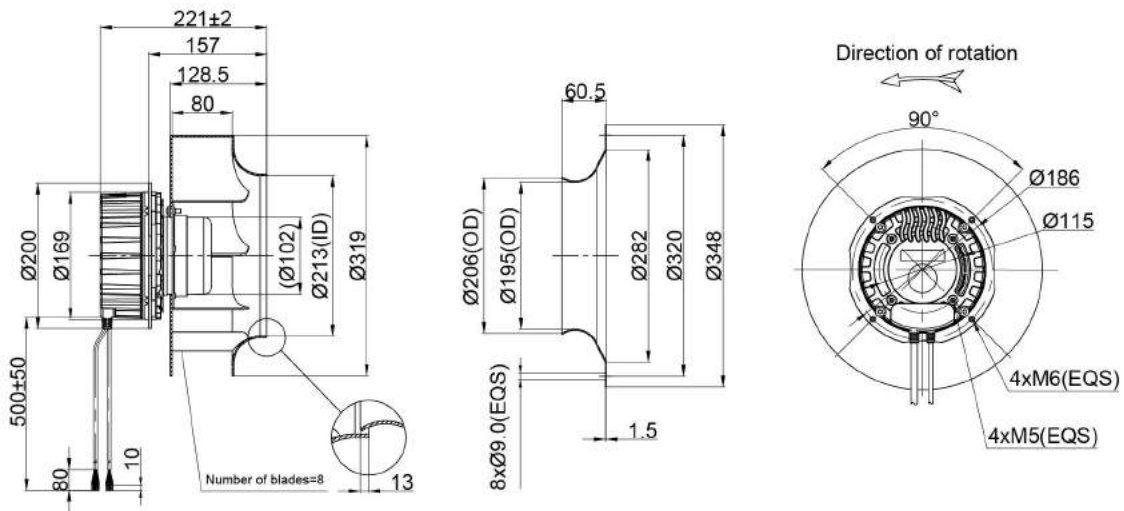

Model	Motor	Bearing System	Rated Voltage	Frequency	Rated Current	Rated Power	Rated Speed	Air Flow	Air Pressure	Sound Level
Part No.	Type	B/S	VAC	Hz	A	W	RPM	M ³ /H	Pa	dB(A)
PB3N310B2E-YZ5	BE102EC	BALL	230	50/60	3.1	700	2850	4380	1590	85

EC Centrifugal Fan Backward Curved Ø310x221mm

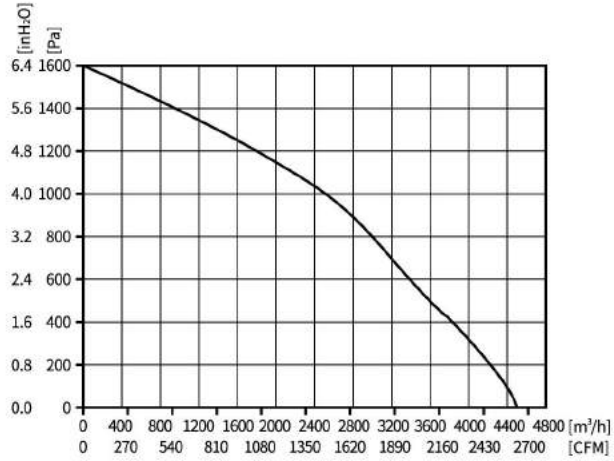

Backward Curved Centrifugal Fans

Motor Type EC BRUSHLESS EXTERNAL ROTOR MOTOR	Speed Control 0-10VDC/PWM	Protection Type IP55	Insulation Class F	Operating Temperature -25°C ~ +60°C	Weight 6.77KG	Wiring Mode E4
---	------------------------------	-------------------------	-----------------------	--	------------------	-------------------

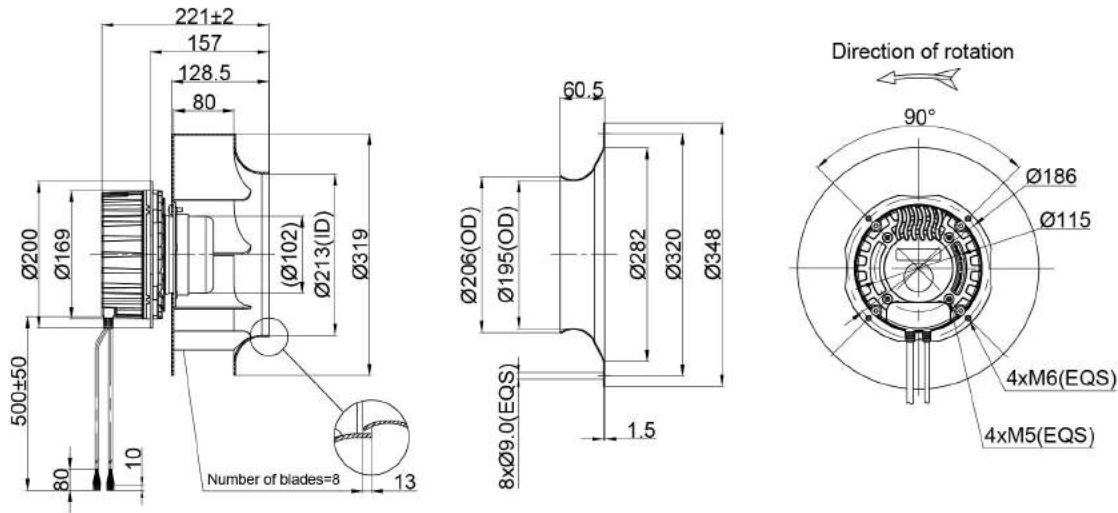

Model	Motor	Bearing System	Rated Voltage	Frequency	Rated Current	Rated Power	Rated Speed	Air Flow	Air Pressure	Sound Level
Part No.	Type	B/S	VAC	Hz	A	W	RPM	M³/H	Pa	dB(A)
PB3N310B4E-YZ5	BE102EC	BALL	380	50/60	1.2	1100	3000	4500	1600	87

EC Centrifugal Fan backward Curved Ø355x257.5mm

Backward Curved Centrifugal Fans

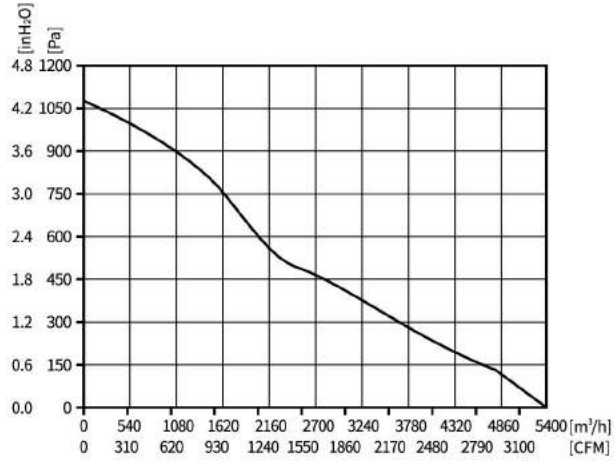

Motor Type EC BRUSHLESS EXTERNAL ROTOR MOTOR	Speed Control 0-10VDC/PWM	Protection Type IP55	Insulation Class F	Operating Temperature -25°C ~ +60°C	Weight 7.44KG	Wiring Mode E3
---	------------------------------	-------------------------	-----------------------	--	------------------	-------------------

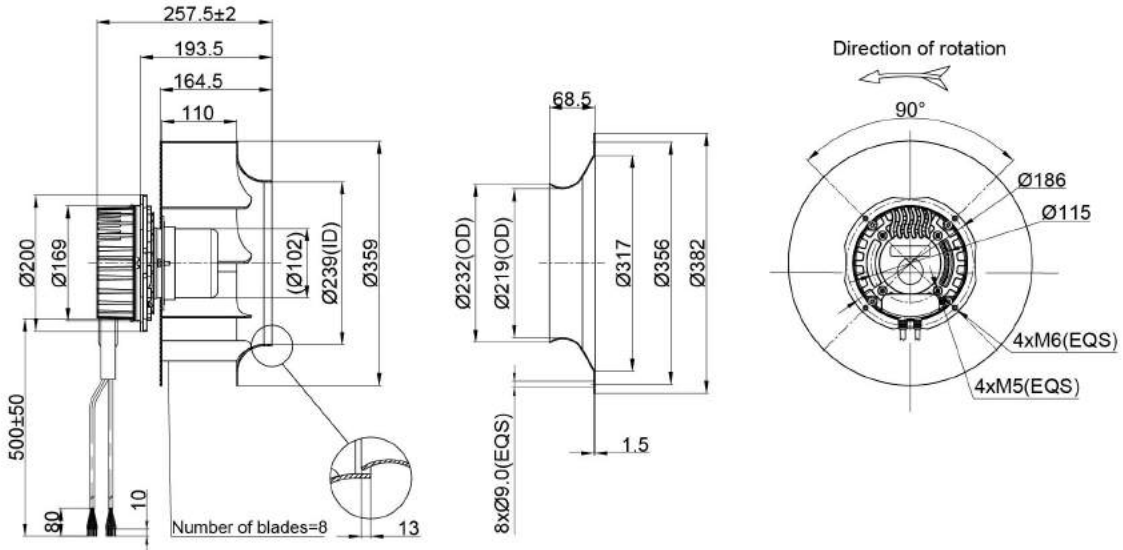

Model	Motor	Bearing System	Rated Voltage	Frequency	Rated Current	Rated Power	Rated Speed	Air Flow	Air Pressure	Sound Level
Part No.	Type	B/S	VAC	Hz	A	W	RPM	M ³ /H	Pa	dB(A)
PB3N355B2E-ZW5	BE102EC	BALL	230	50/60	3.0	700	2150	5400	1080	84

EC Centrifugal Fan Backward Curved Ø355x257.5mm

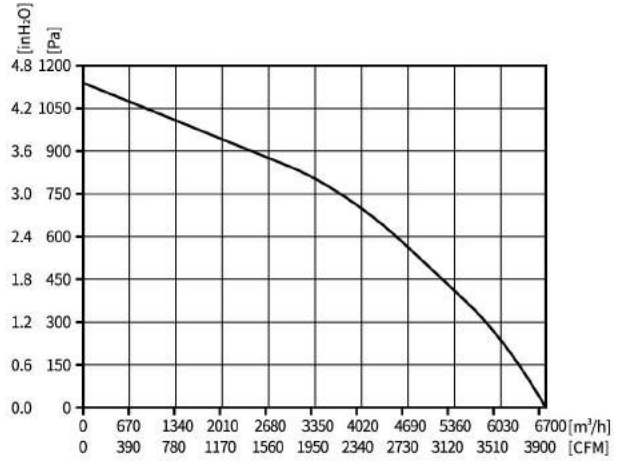

Backward Curved Centrifugal Fans

Motor Type EC BRUSHLESS EXTERNAL ROTOR MOTOR	Speed Control 0-10VDC/PWM	Protection Type IP55	Insulation Class F	Operating Temperature -25°C ~ +60°C	Weight 7.44KG	Wiring Mode E4
---	------------------------------	-------------------------	-----------------------	--	------------------	-------------------

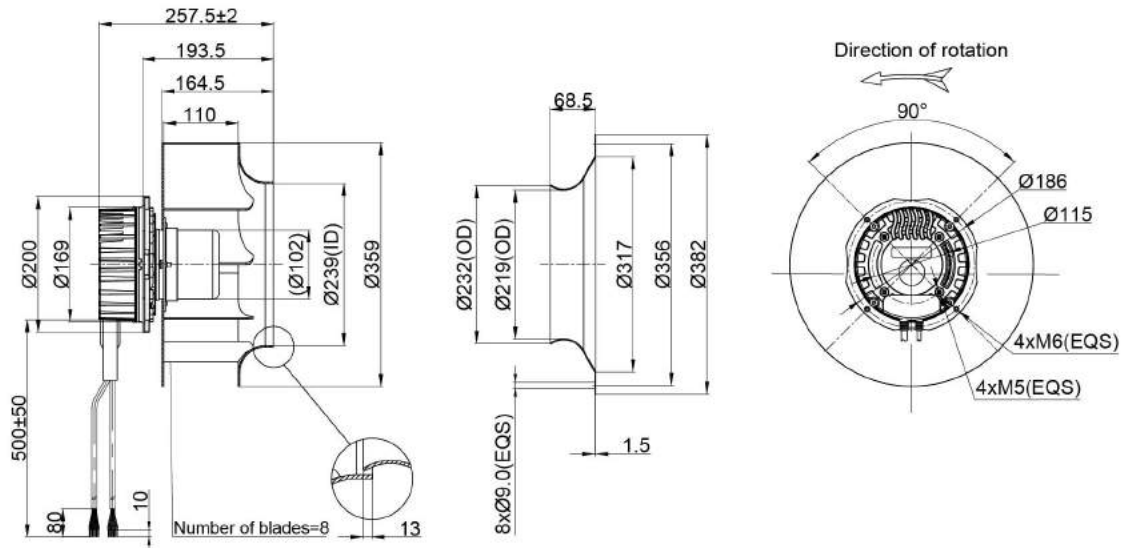

Model	Motor	Bearing System	Rated Voltage	Frequency	Rated Current	Rated Power	Rated Speed	Air Flow	Air Pressure	Sound Level
Part No.	Type	B/S	VAC	Hz	A	W	RPM	M³/H	Pa	dB(A)
PB3N355B4E-ZW5	BE102EC	BALL	380	50/60	1.8	1100	2500	6700	1150	86

EC Centrifugal Fan backward Curved Ø400x278mm

Backward Curved Centrifugal Fans

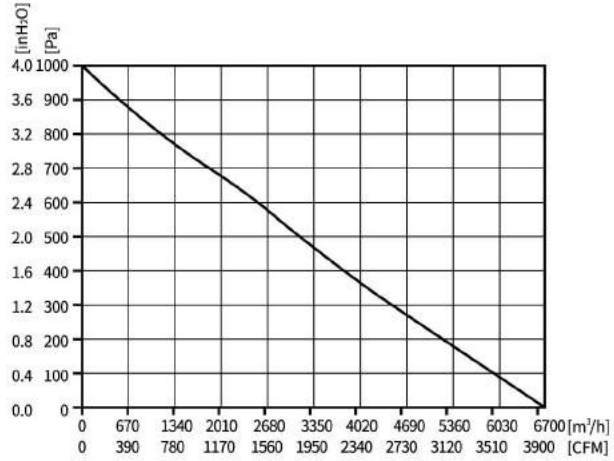

Motor Type EC BRUSHLESS EXTERNAL ROTOR MOTOR	Speed Control 0-10VDC/PWM	Protection Type IP55	Insulation Class F	Operating Temperature -25°C ~ +60°C	Weight 9.94KG	Wiring Mode E3
---	------------------------------	-------------------------	-----------------------	--	------------------	-------------------

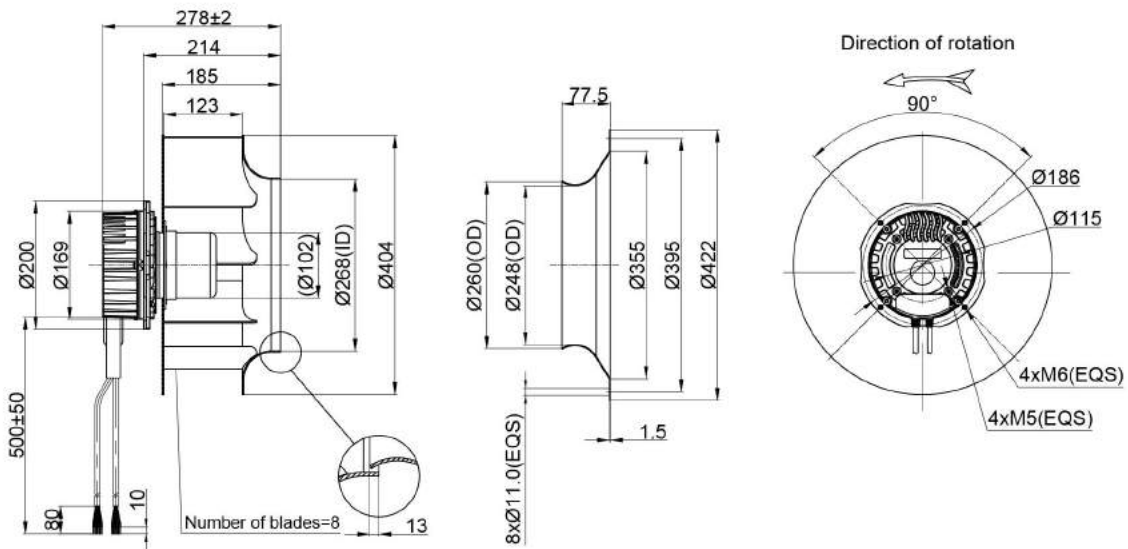

Model	Motor	Bearing System	Rated Voltage	Frequency	Rated Current	Rated Power	Rated Speed	Air Flow	Air Pressure	Sound Level
Part No.	Type	B/S	VAC	Hz	A	W	RPM	M ³ /H	Pa	dB(A)
PB3N400B2E-ZW5	BE102EC	BALL	230	50/60	3.1	700	1750	6700	1000	83

EC Centrifugal Fan Backward Curved Ø400x278mm

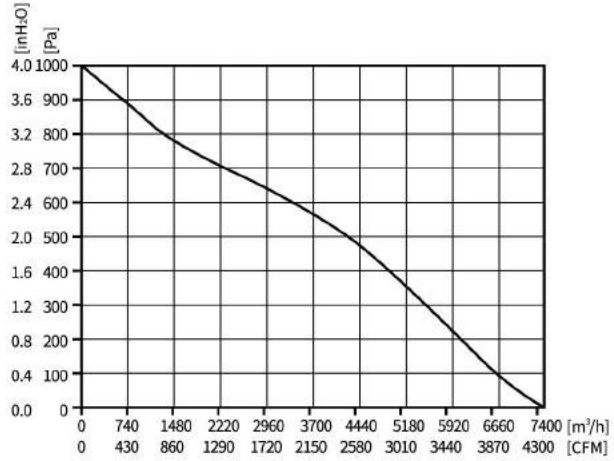

Backward Curved Centrifugal Fans

Motor Type EC BRUSHLESS EXTERNAL ROTOR MOTOR	Speed Control 0-10VDC/PWM	Protection Type IP55	Insulation Class F	Operating Temperature -25°C~+60°C	Weight 9.94KG	Wiring Mode E4
---	------------------------------	-------------------------	-----------------------	--------------------------------------	------------------	-------------------

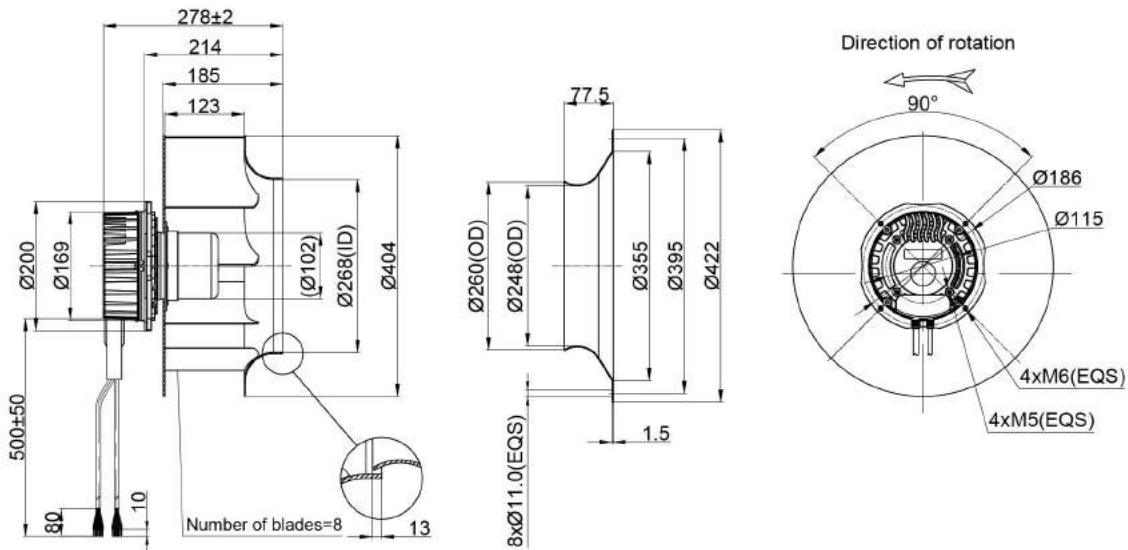

Model	Motor	Bearing System	Rated Voltage	Frequency	Rated Current	Rated Power	Rated Speed	Air Flow	Air Pressure	Sound Level
Part No.	Type	B/S	VAC	Hz	A	W	RPM	M³/H	Pa	dB(A)
PB3N400B4E-ZW5	BE102EC	BALL	380	50/60	1.2	1300	2000	7400	1000	85

EC Centrifugal Fan backward Curved Ø450x304mm

Backward Curved Centrifugal Fans

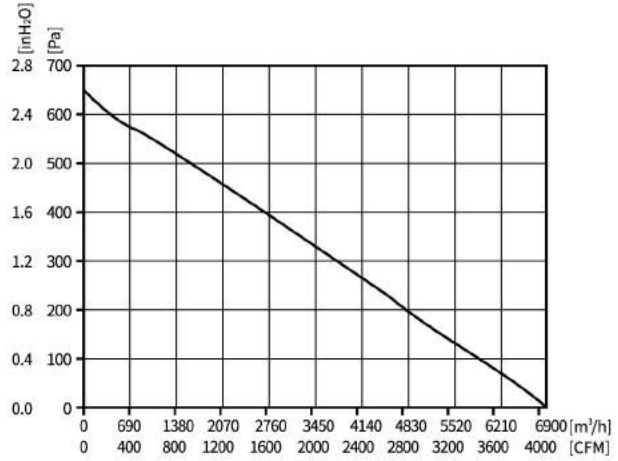

Motor Type EC BRUSHLESS EXTERNAL ROTOR MOTOR	Speed Control 0-10VDC/PWM	Protection Type IP55	Insulation Class F	Operating Temperature -25°C ~ +60°C	Weight 9.23KG	Wiring Mode E3
---	------------------------------	-------------------------	-----------------------	--	------------------	-------------------

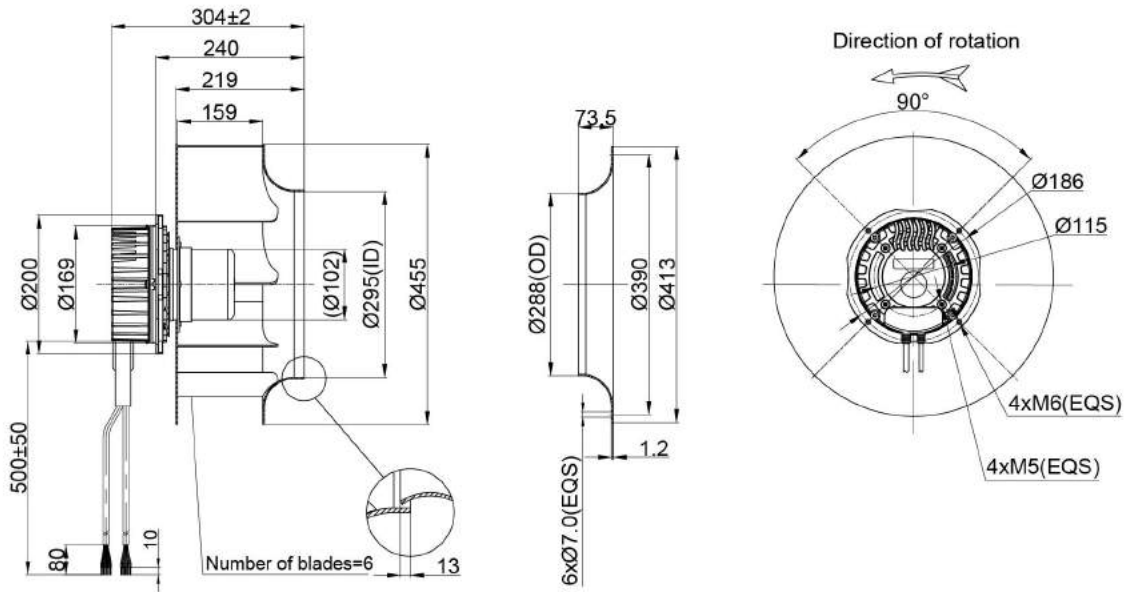

Model	Motor	Bearing System	Rated Voltage	Frequency	Rated Current	Rated Power	Rated Speed	Air Flow	Air Pressure	Sound Level
Part No.	Type	B/S	VAC	Hz	A	W	RPM	M ³ /H	Pa	dB(A)
PB3N450B2E-ZW5	BE102EC	BALL	230	50/60	3.2	700	1550	6900	650	80

EC Centrifugal Fan Backward Curved Ø450x304mm

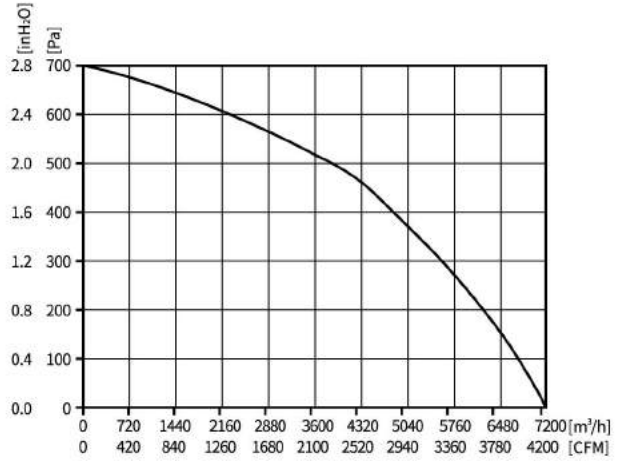

Backward Curved Centrifugal Fans

Motor Type EC BRUSHLESS EXTERNAL ROTOR MOTOR	Speed Control 0-10VDC/PWM	Protection Type IP55	Insulation Class F	Operating Temperature -25°C ~ +60°C	Weight 9.23KG	Wiring Mode E4
---	------------------------------	-------------------------	-----------------------	--	------------------	-------------------

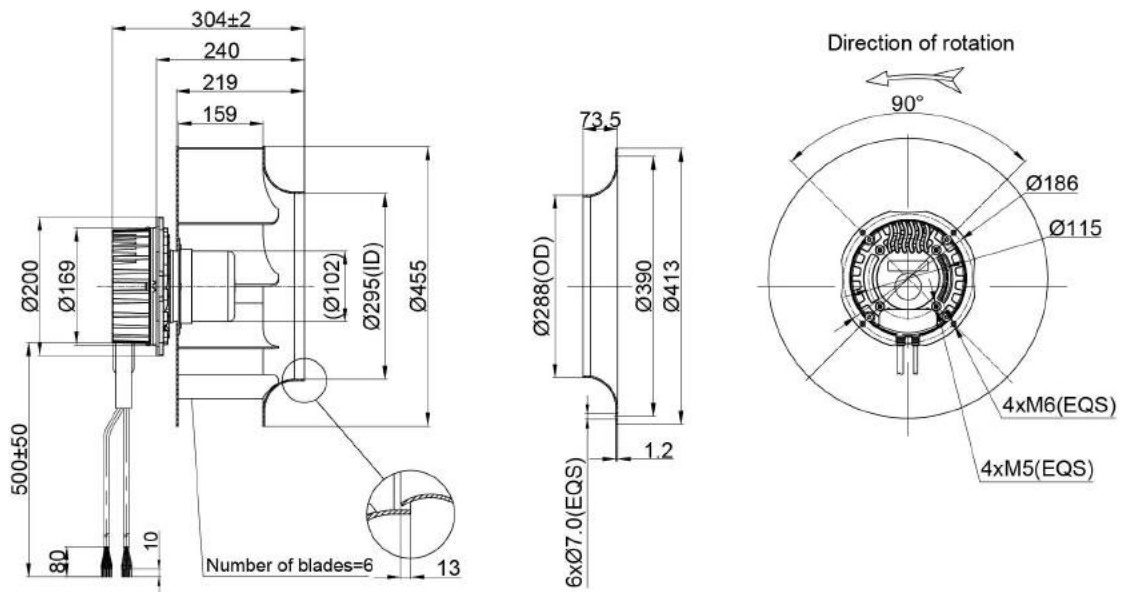

Model	Motor	Bearing System	Rated Voltage	Frequency	Rated Current	Rated Power	Rated Speed	Air Flow	Air Pressure	Sound Level
Part No.	Type	B/S	VAC	Hz	A	W	RPM	M³/H	Pa	dB(A)
PB3N450B4E-ZW5	BE102EC	BALL	380	50/60	1.5	1000	1800	7200	700	83